

REGULATED PRESSURE	FORCE
60 PSI	2721
80 PSI	3629
100 PSI	4356

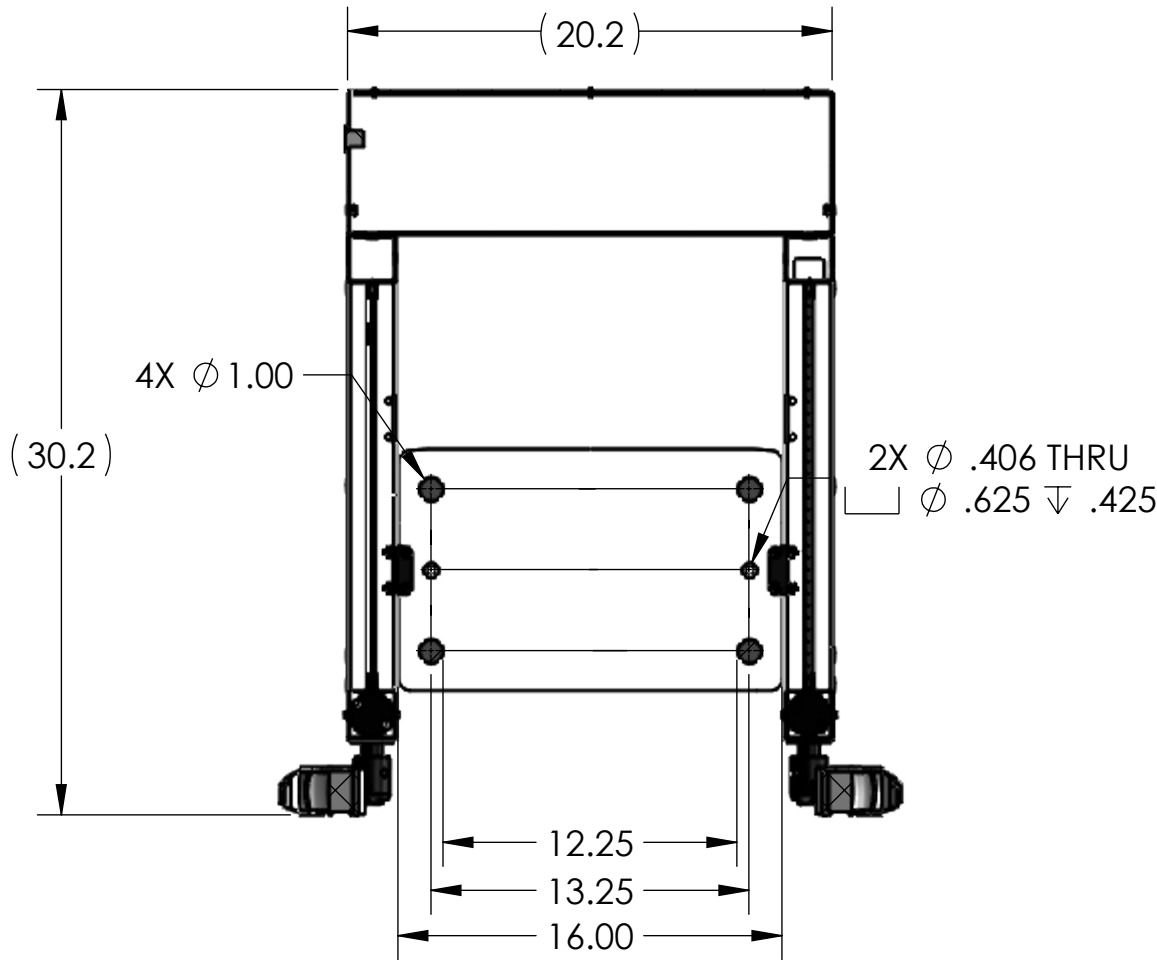

OPTIONAL TOOL ADAPTER:  
FOR USE WITH DIE SETS  
(3/4"-10 UNC  $\nabla$  1.50)  
(4) LENGTHS AVAILABLE

DETAIL D  
SCALE 1:3

FRONT TUBES & WIRE MESH ARE REMOVABLE

FULLY ADJUSTABLE OPTO TOUCH BUTTONS

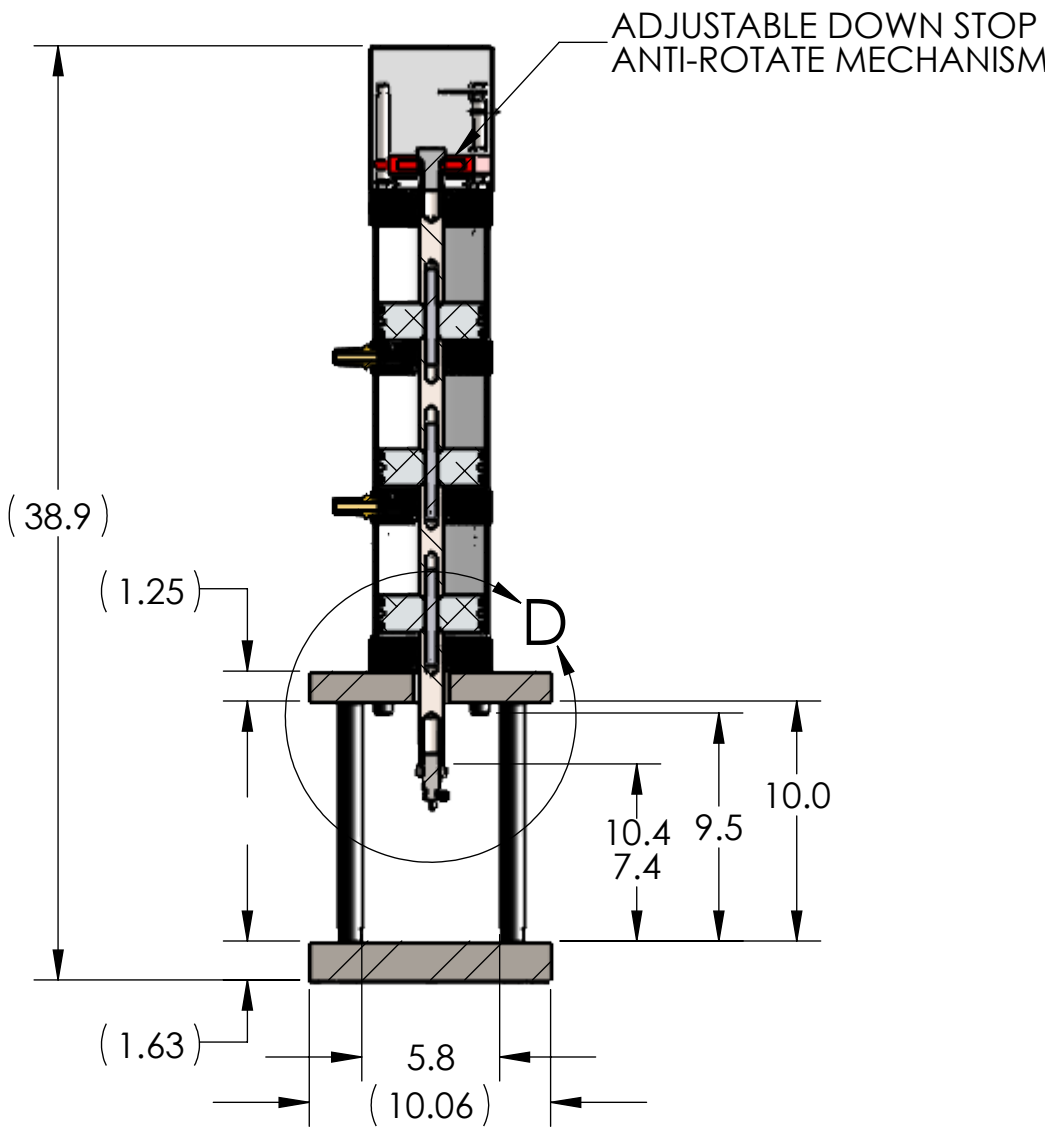
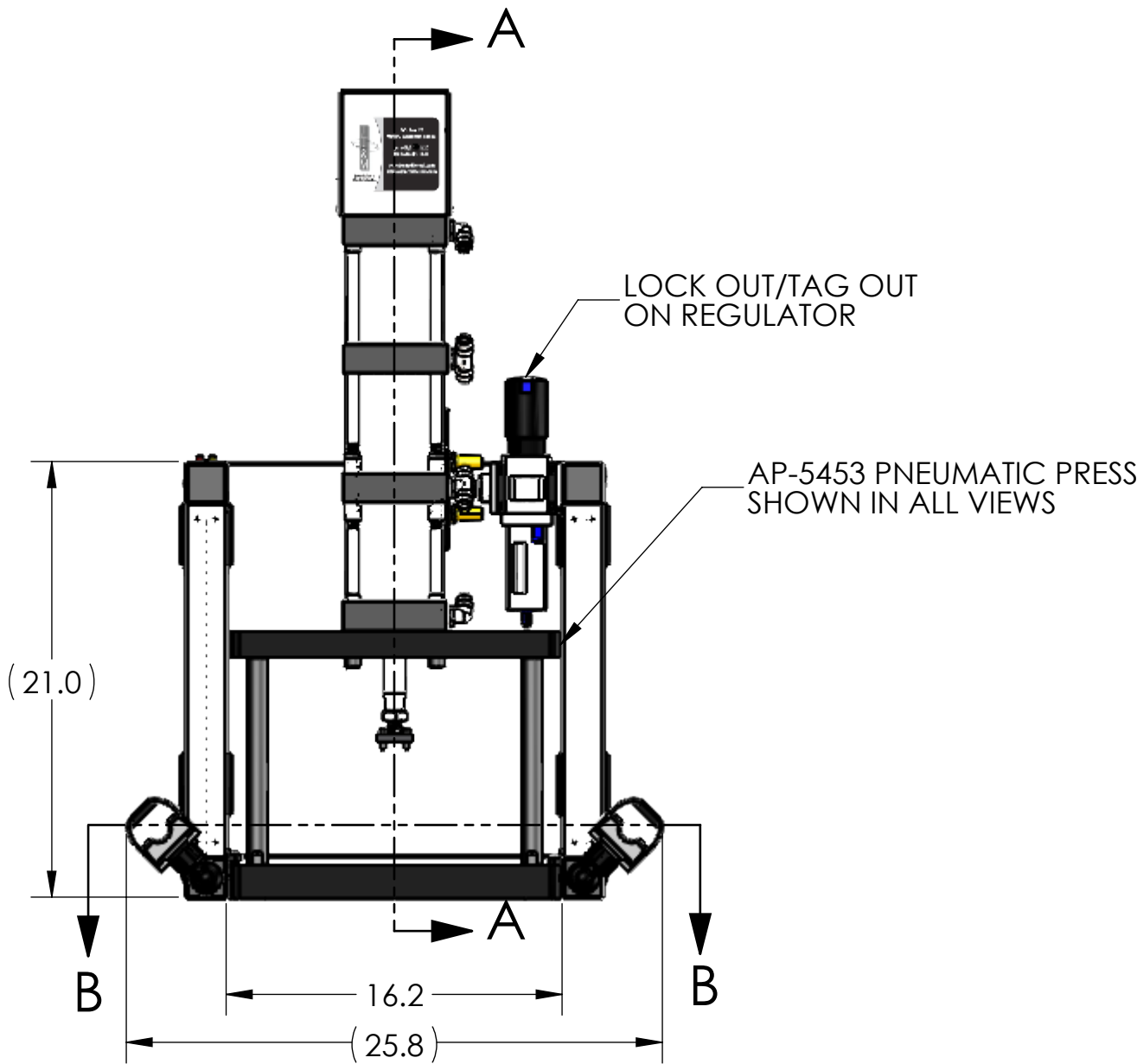
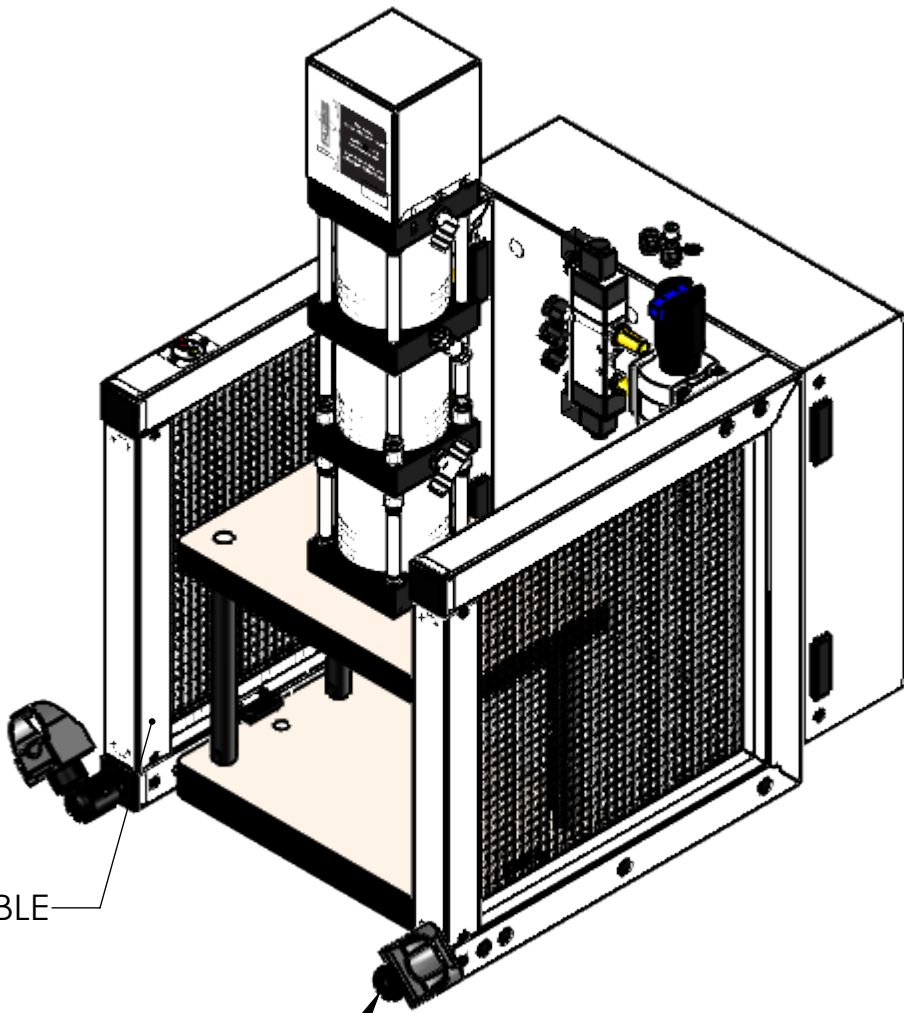

NOTES:

- PRESS OPERATES ON LOW VOLTAGE (24V DC).
- LED LIGHT COMES STANDARD.
- OPTIONAL FORCE MONITORING SYSTEM AVAILABLE UPON REQUEST (NOT SHOWN).
- CYLINDER ROD SHOWN IN EXTENDED POSITION.
- ALL CYLINDERS COME STANDARD WITH 3" OF STROKE.  
LONGER CYLINDER STROKE LENGTHS AVAILABLE UPON REQUEST (UP TO 12").
- PRESS COMES STANDARD WITH 10" LONG POSTS.  
ALTERNATE POST LENGTHS AVAILABLE UPON REQUEST (UP TO 18").
- TOOL ADAPTER SHOWN DOES NOT COME STANDARD.
- REMOVED GUARD IN RIGHT VIEW FOR CLARITY.

THIS DRAWING WAS PRINTED ON 1/6/2021

UNLESS OTHERWISE SPECIFIED:		NAME	DATE
DIMENSIONS ARE IN INCHES		RKM	1/6/21
TOLERANCES:			
FRACTIONAL $\pm$ 0.15			
ANGULAR: MACH $\pm$ 0.5 BEND $\pm$ 0.5			
TWO PLACE DECIMAL $\pm$ 0.01			
THREE PLACE DECIMAL $\pm$ 0.005			
FOUR PLACE DECIMAL $\pm$ 0.0005			
INTERPRET GEOMETRIC TOLERANCING PER: ASME Y14.5-1994			
MATERIAL			
FINISH			
DO NOT SCALE DRAWING			
SEE DETAILS			
SEE DETAILS			
DO NOT SCALE DRAWING			
BREAK ALL SHARP EDGES			
J & M			
Janesville Tool & Manufacturing, Inc.			
Janesville Tool & Manufacturing Inc.			
3930 Enterprise Drive			
Janesville, WI 53546			
Phone: 608-314-1620, Fax 608-314-1625			
TITLE:			
AP-5453 THREE STAGE			
SIZE	DWG. NO.	REV	
C	AP-5453-000-00	-	
SCALE: 1:8	WEIGHT: 231.97	SHEET 2 OF 3	