

REGULATED PRESSURE	FORCE
60 PSI	1814
80 PSI	2419
100 PSI	3024

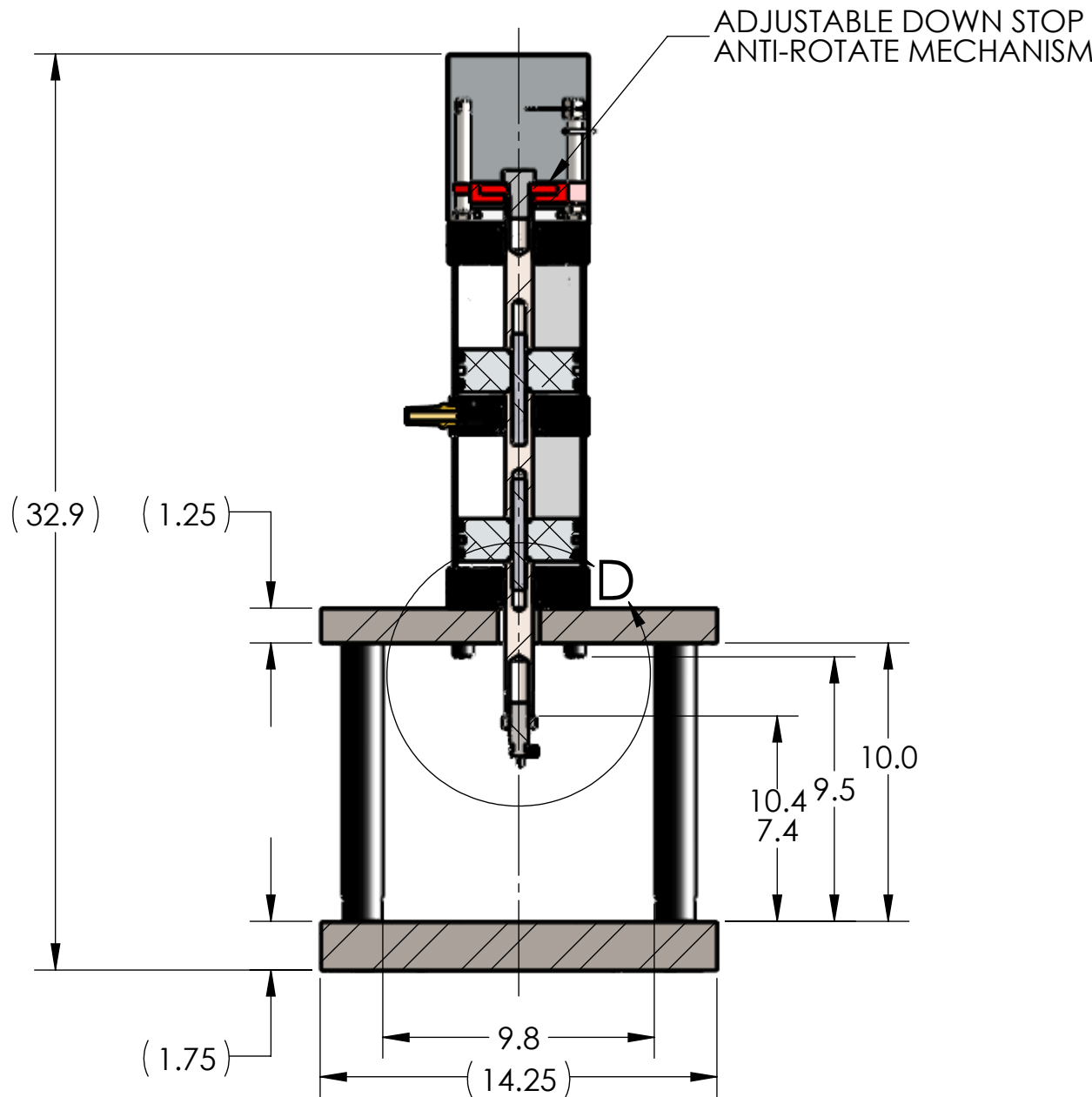
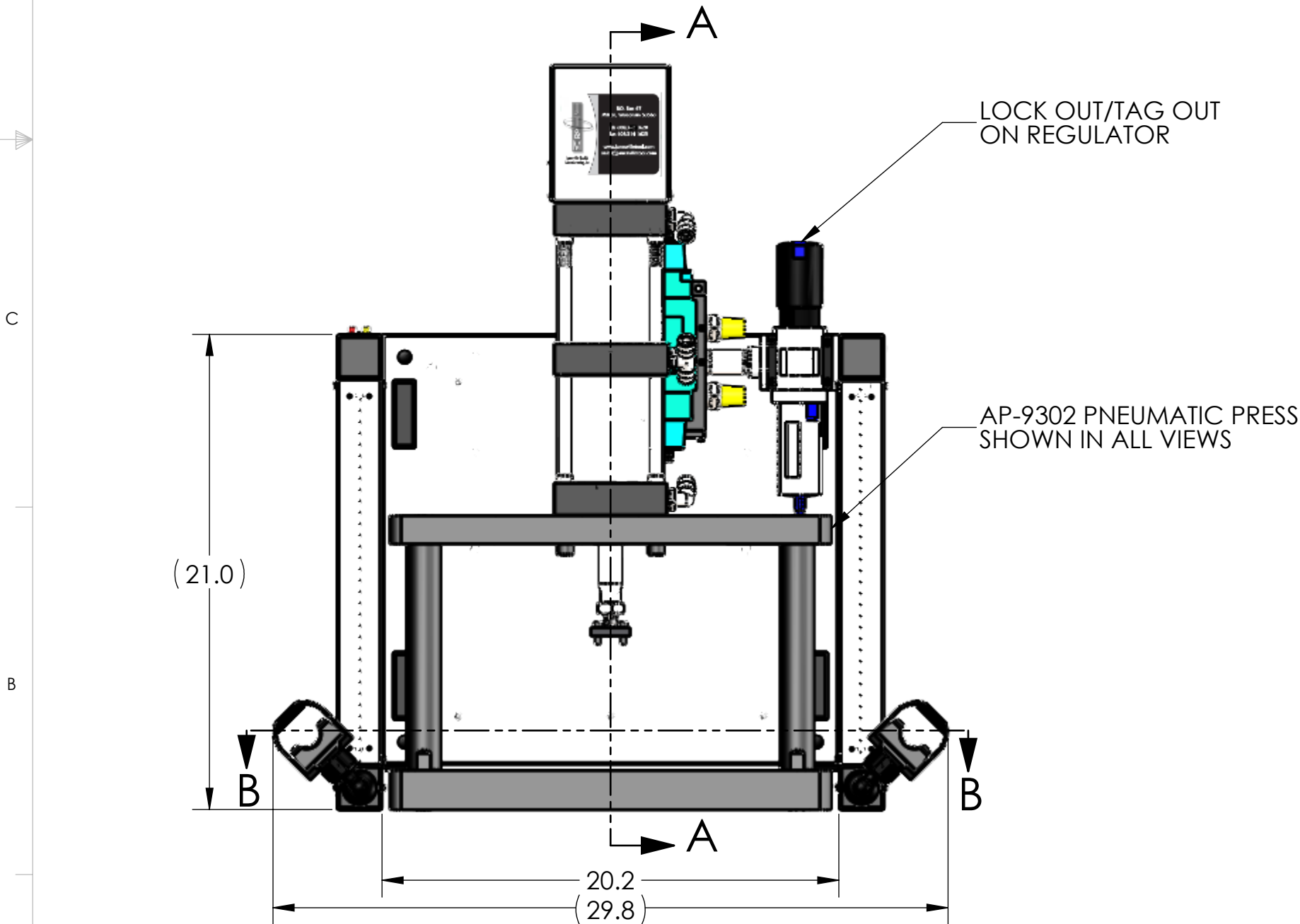
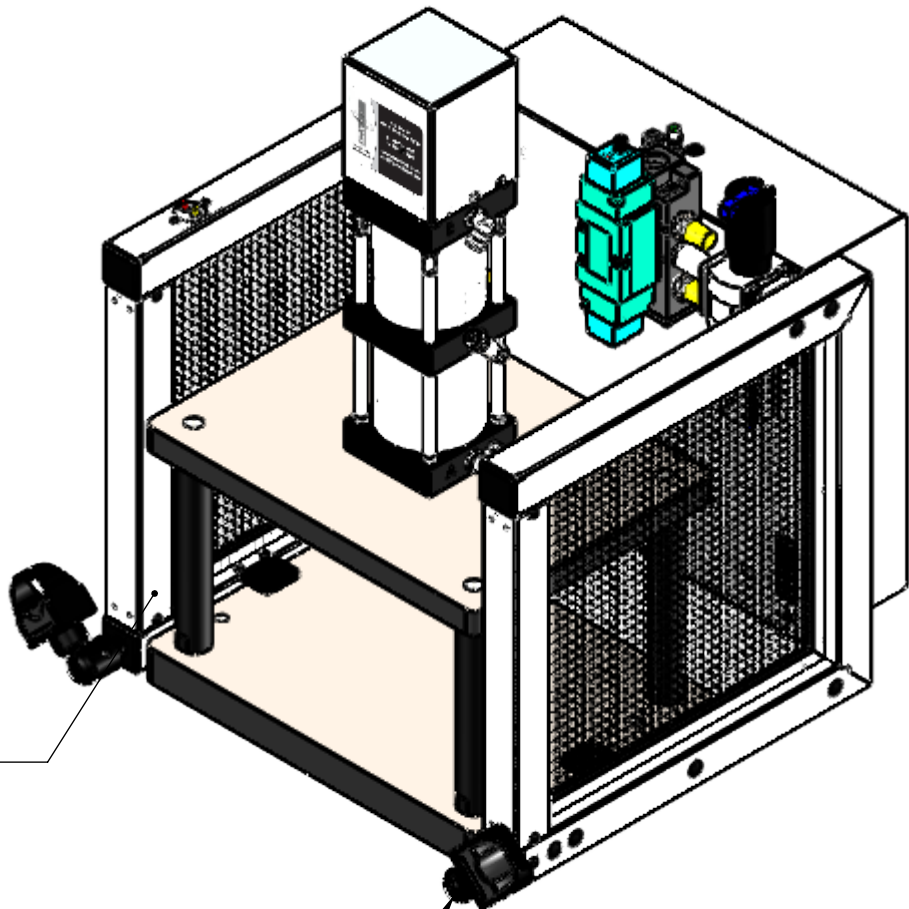
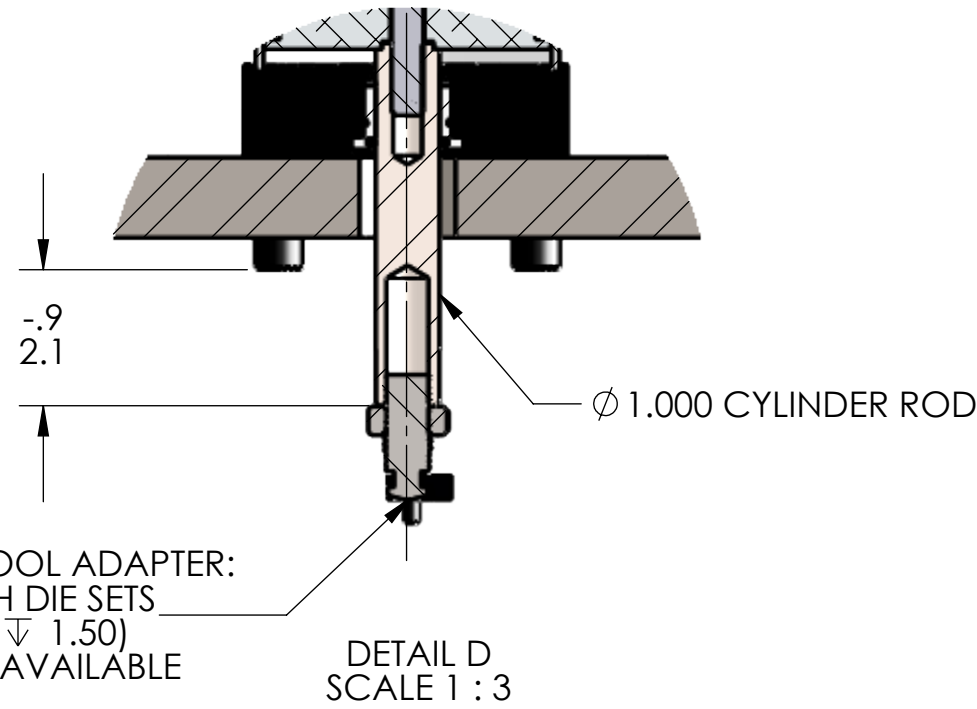
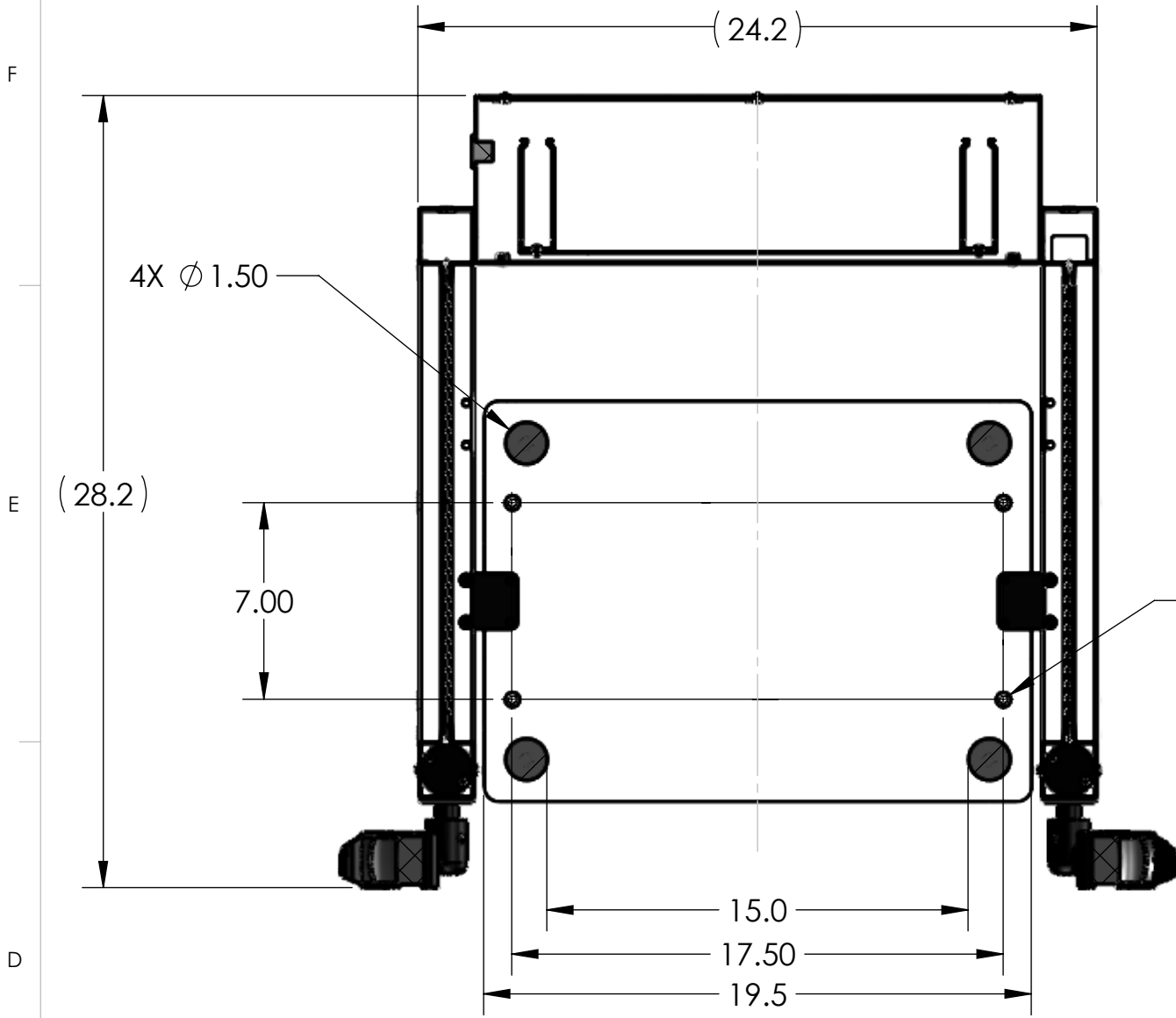

NOTES:

- PRESS OPERATES ON LOW VOLTAGE (24V DC).
- LED LIGHT COMES STANDARD.
- OPTIONAL FORCE MONITORING SYSTEM AVAILABLE UPON REQUEST (NOT SHOWN).
- CYLINDER ROD SHOWN IN EXTENDED POSITION.
- ALL CYLINDERS COME STANDARD WITH 3" OF STROKE.
LONGER CYLINDER STROKE LENGTHS AVAILABLE UPON REQUEST (UP TO 12").
- PRESS COMES STANDARD WITH 10" LONG POSTS.
ALTERNATE POST LENGTHS AVAILABLE UPON REQUEST (UP TO 18").
- TOOL ADAPTER SHOWN DO NOT COME STANDARD.
- REMOVED GUARD IN RIGHT VIEW FOR CLARITY.

THIS DRAWING WAS PRINTED ON 9/2/2021

UNLESS OTHERWISE SPECIFIED:		
DIMENSIONS ARE IN INCHES		
TOLERANCES:		
FRACTIONAL ± 0.15		
ANGULAR: MACH ± 0.5 BEND ± 0.5		
TWO PLACE DECIMAL ± 0.01		
THREE PLACE DECIMAL ± 0.005		
FOUR PLACE DECIMAL ± 0.0005		
INTERPRET GEOMETRIC TOLERANCING PER: ASME Y14.5-1994		
MATERIAL		
FINISH		
DO NOT SCALE DRAWING		

NAME	DATE
RKM	5-4-21
DRAWN	
CHECKED	
ENG APPR.	
MFG APPR.	
Q.A.	
COMMENTS:	

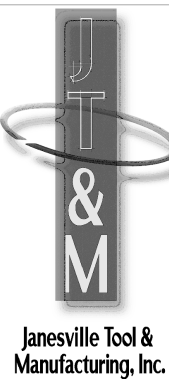

Janesville Tool & Manufacturing Inc. 3930 Enterprise Drive Janesville, WI 53546 Phone: 608-314-1620, Fax 608-314-1625		
TITLE: AP-9302 TWO STAGE		
SIZE C	DWG. NO. AP-9302-000-00	REV -
SCALE: 1:6 WEIGHT: 352.74 SHEET 1 OF 5		