

REGULATED PRESSURE	FORCE
60 PSI	3726
80 PSI	4968
100 PSI	6210

F

E

D

C

B

A

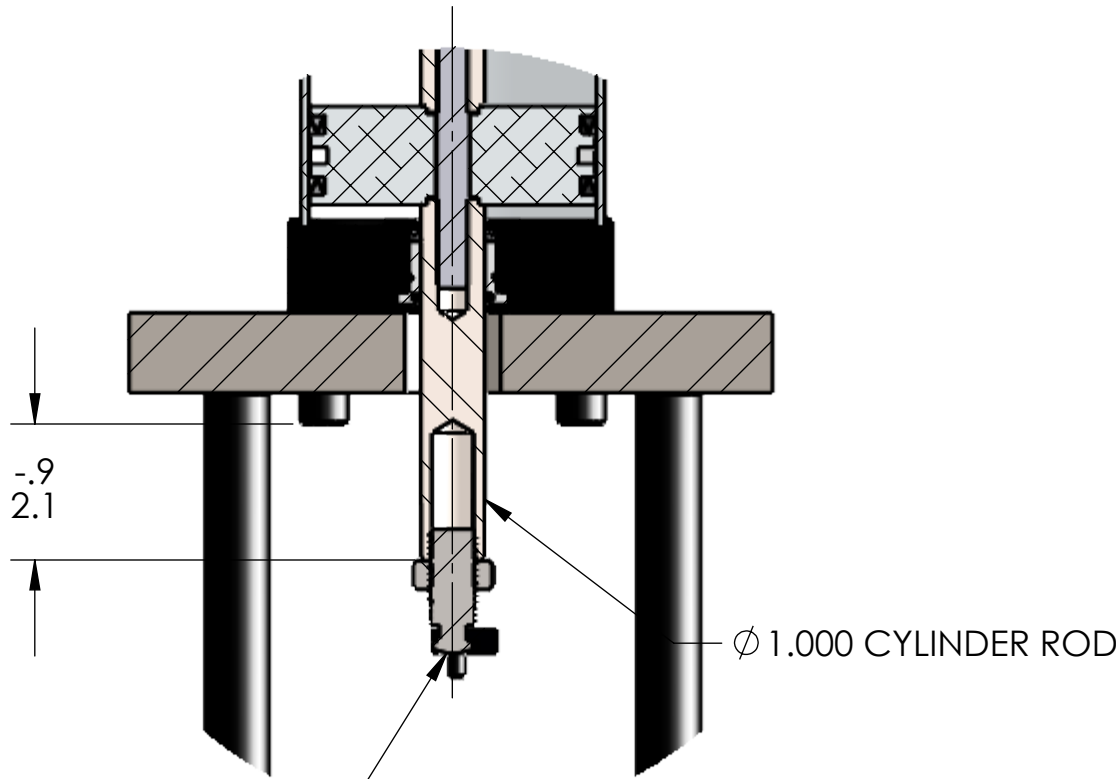
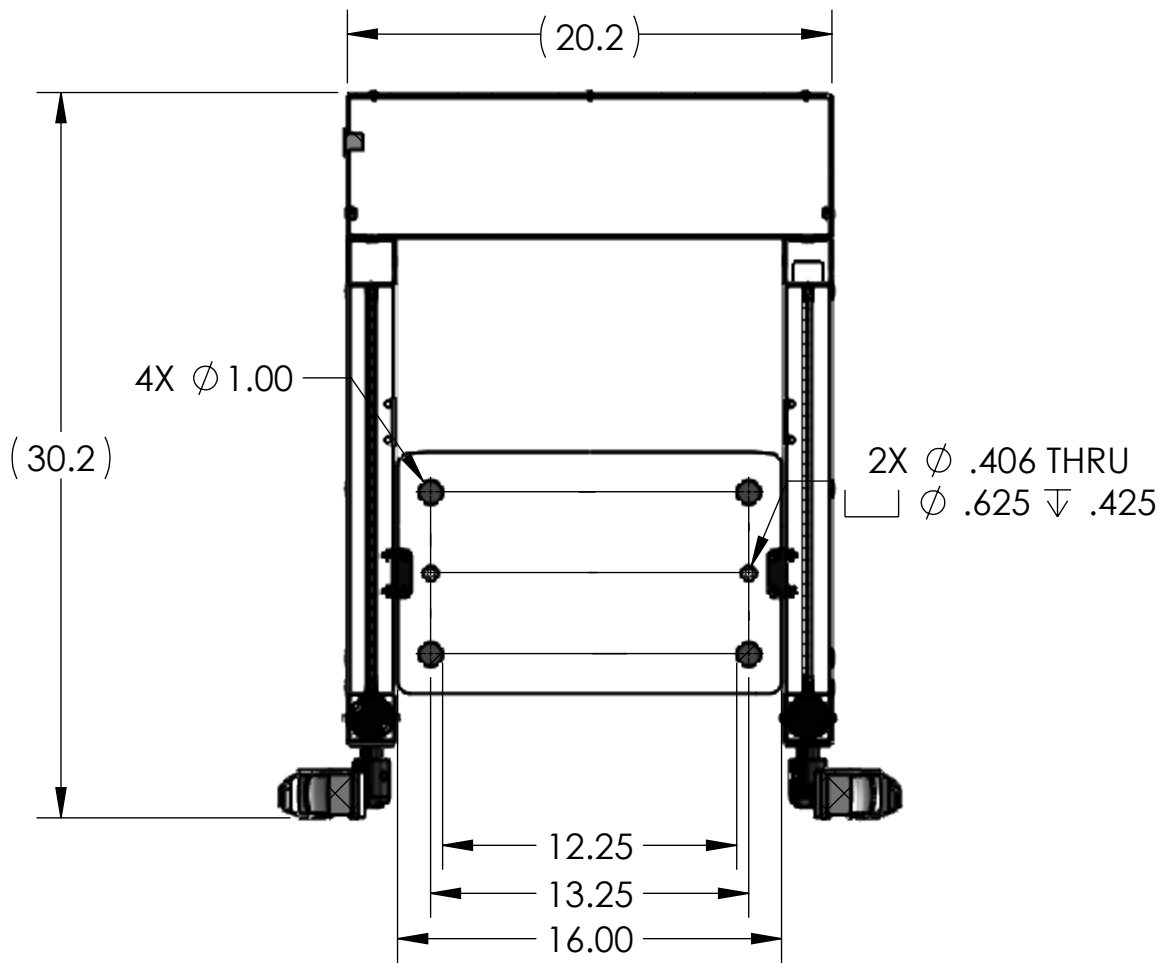

OPTIONAL TOOL ADAPTER:  
FOR USE WITH DIE SETS  
(3/4"-10 UNC ± 1.50)  
(4) LENGTHS AVAILABLE

DETAIL D  
SCALE 1:3

FRONT TUBES & WIRE MESH ARE REMOVABLE

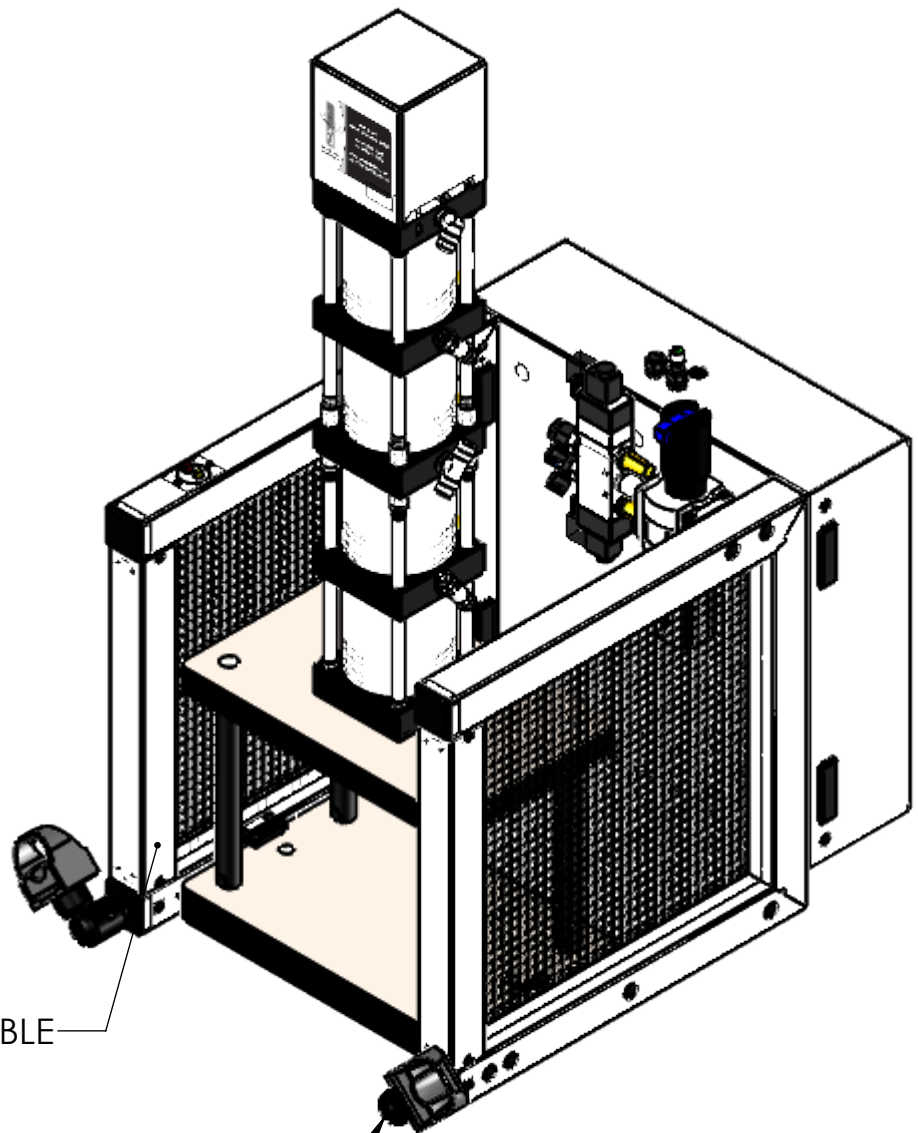

FULLY ADJUSTABLE OPTO TOUCH BUTTONS

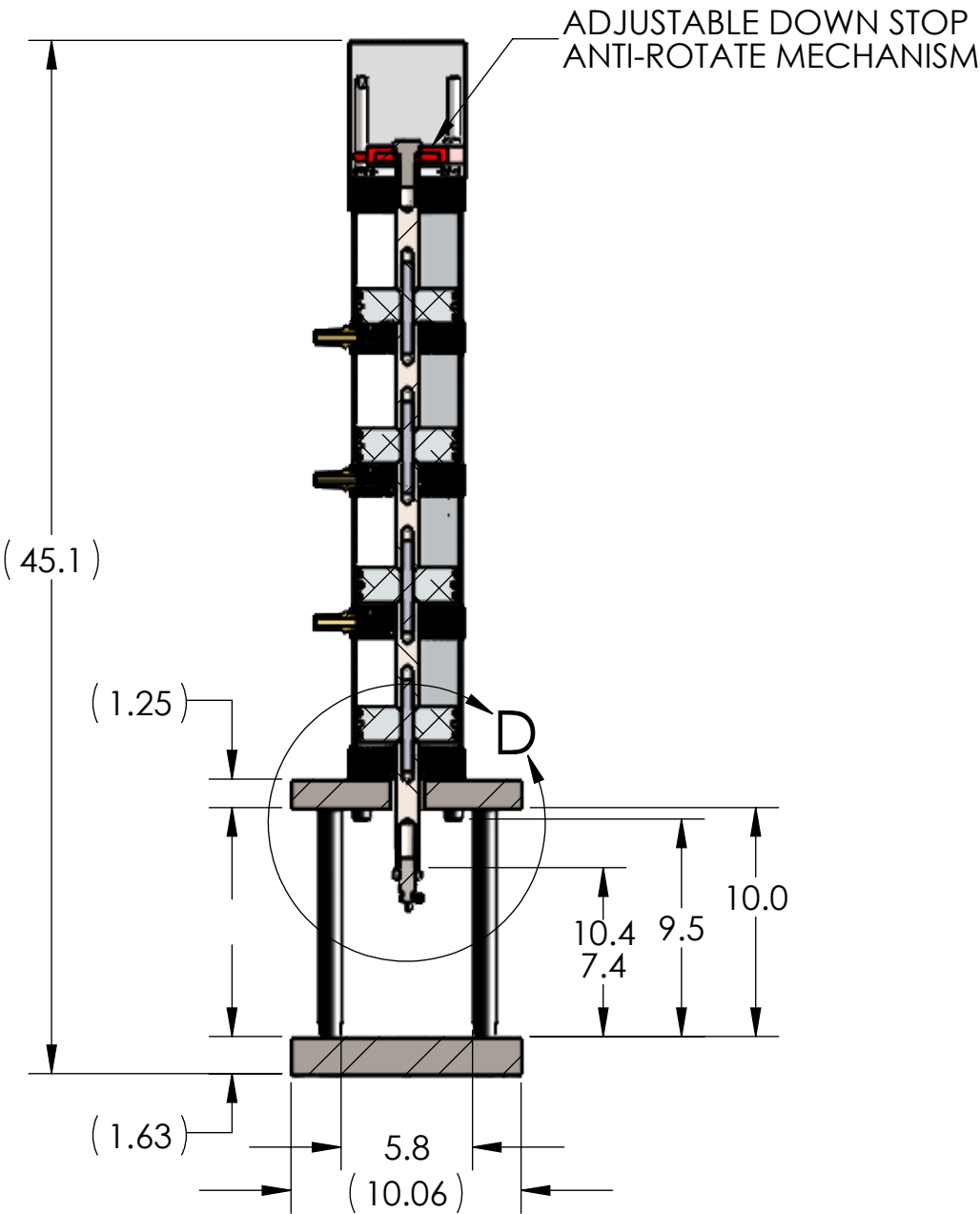
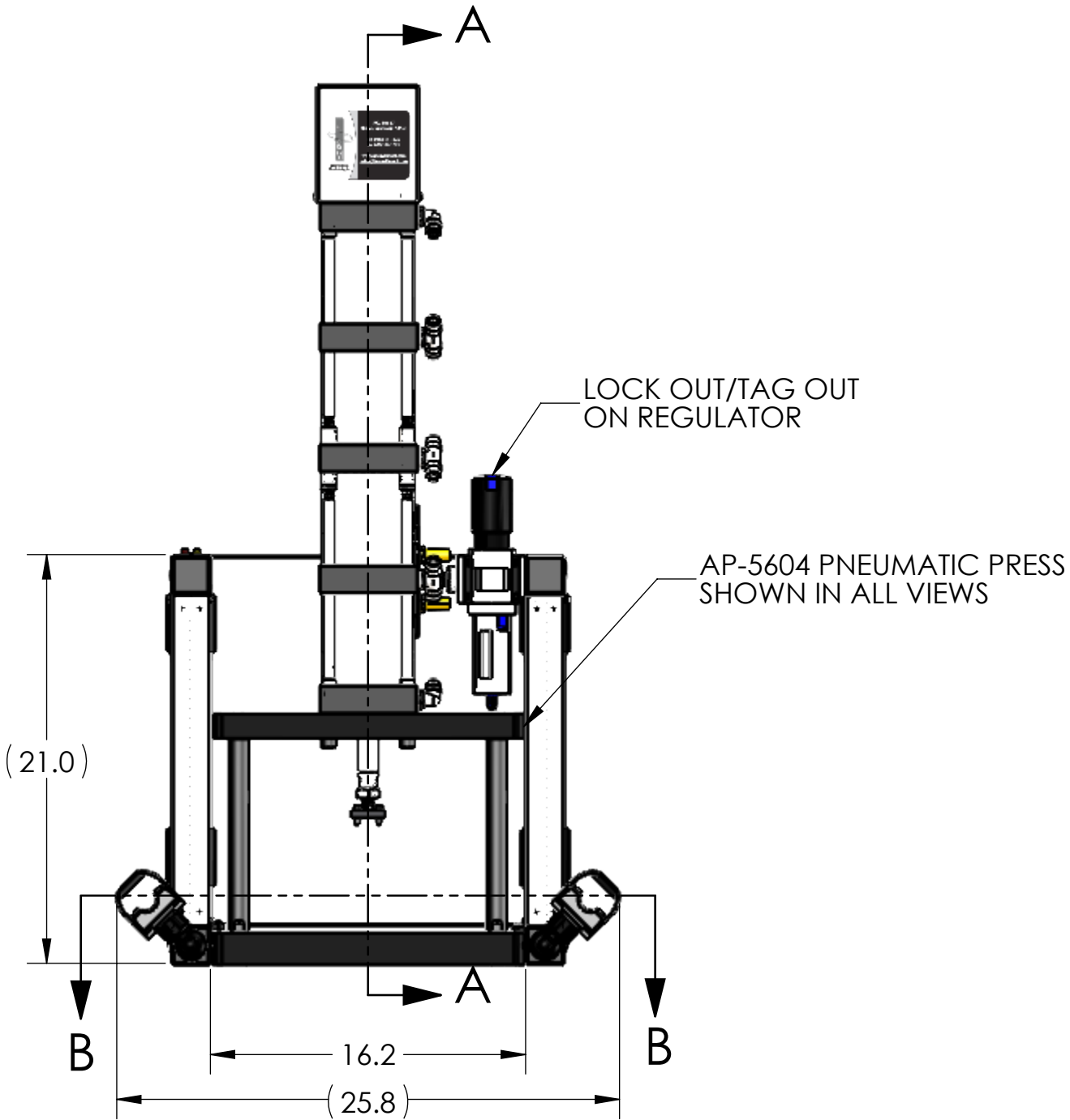

NOTES:

- PRESS OPERATES ON LOW VOLTAGE (24V DC).
- LED LIGHT COMES STANDARD.
- OPTIONAL FORCE MONITORING SYSTEM AVAILABLE UPON REQUEST (NOT SHOWN).
- CYLINDER ROD SHOWN IN EXTENDED POSITION.
- ALL CYLINDERS COME STANDARD WITH 3" OF STROKE.  
LONGER CYLINDER STROKE LENGTHS AVAILABLE UPON REQUEST (UP TO 12").
- PRESS COMES STANDARD WITH 10" LONG POSTS.  
ALTERNATE POST LENGTHS AVAILABLE UPON REQUEST (UP TO 18").
- TOOL ADAPTER SHOWN DOES NOT COME STANDARD.
- REMOVED GUARD IN RIGHT VIEW FOR CLARITY.

THIS DRAWING WAS PRINTED ON 1/6/2021

UNLESS OTHERWISE SPECIFIED:	DRAWN	NAME	DATE
DIMENSIONS ARE IN INCHES	RKM		1/6/21
TOLERANCES:	CHECKED		
FRACTIONAL ± 0.15	ENG APPR.		
ANGULAR: MACH ± 0.5 BEND ± 0.5	MFG APPR.		
TWO PLACE DECIMAL ± 0.01			
THREE PLACE DECIMAL ± 0.005			
FOUR PLACE DECIMAL ± 0.0005			
INTERPRET GEOMETRIC TOLERANCING PER: ASME Y14.5-1994	Q.A.		
MATERIAL	COMMENTS:		
FINISH			
DO NOT SCALE DRAWING			

PROPRIETARY AND CONFIDENTIAL  
THE INFORMATION CONTAINED IN THIS DRAWING IS THE SOLE PROPERTY OF JANESVILLE TOOL & MANUFACTURING INC. ANY REPRODUCTION IN PART OR AS A WHOLE WITHOUT THE WRITTEN PERMISSION OF JANESVILLE TOOL & MANUFACTURING INC. IS PROHIBITED.

BREAK ALL SHARP EDGES

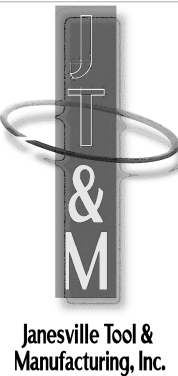

Janesville Tool & Manufacturing Inc. 3930 Enterprise Drive Janesville, WI 53546 Phone: 608-314-1620, Fax 608-314-1625		
TITLE: AP-5604 FOUR STAGE		
SIZE C	DWG. NO. AP-5604-000-00	REV -
SCALE: 1:8 WEIGHT: 240.96 SHEET 3 OF 3		