

REGULATED PRESSURE	FORCE
60 PSI	907
80 PSI	1210
100 PSI	1512

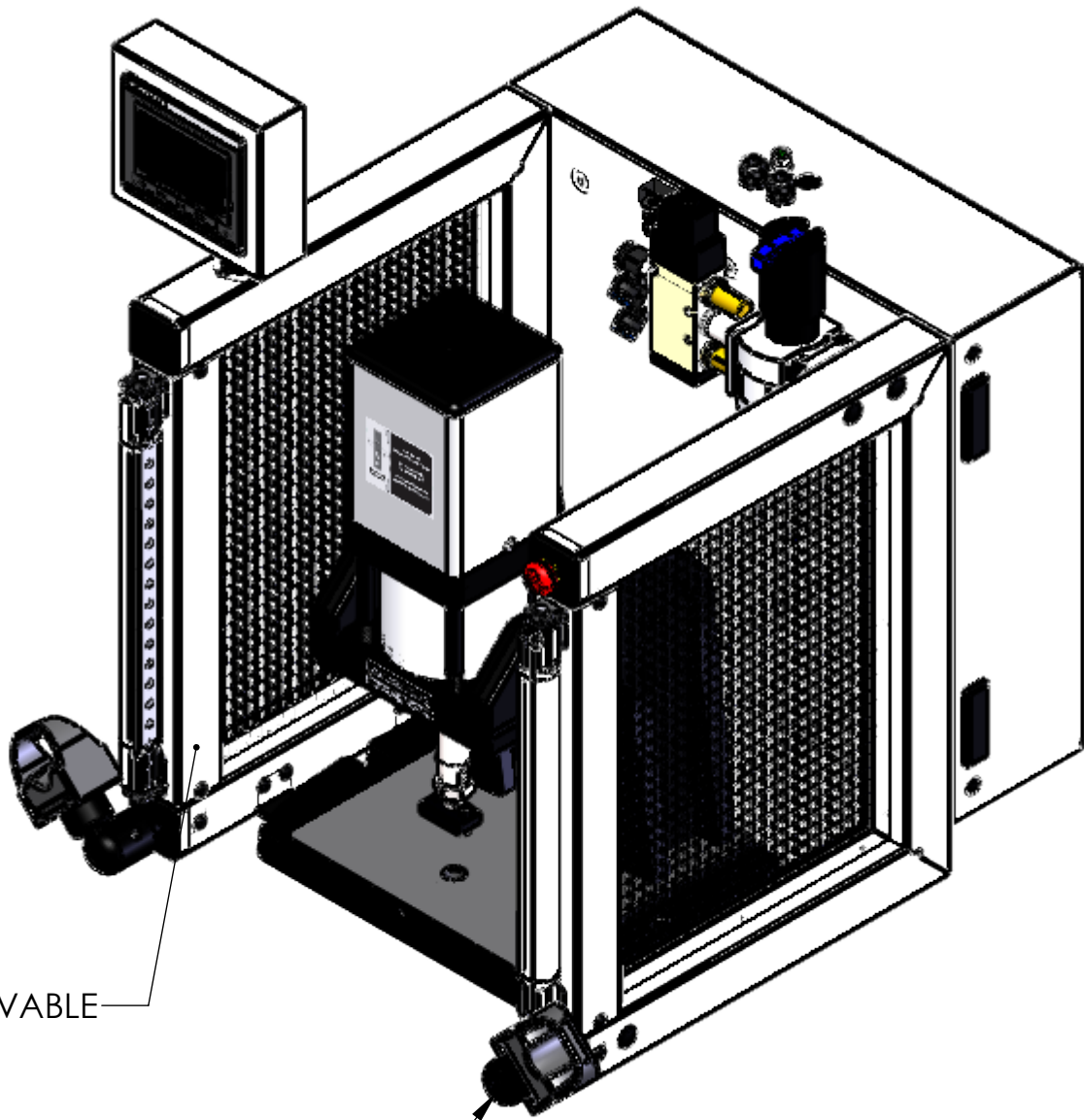

FRONT TUBES & WIRE MESH ARE REMOVABLE

FULLY ADJUSTABLE OPTO TOUCH BUTTONS

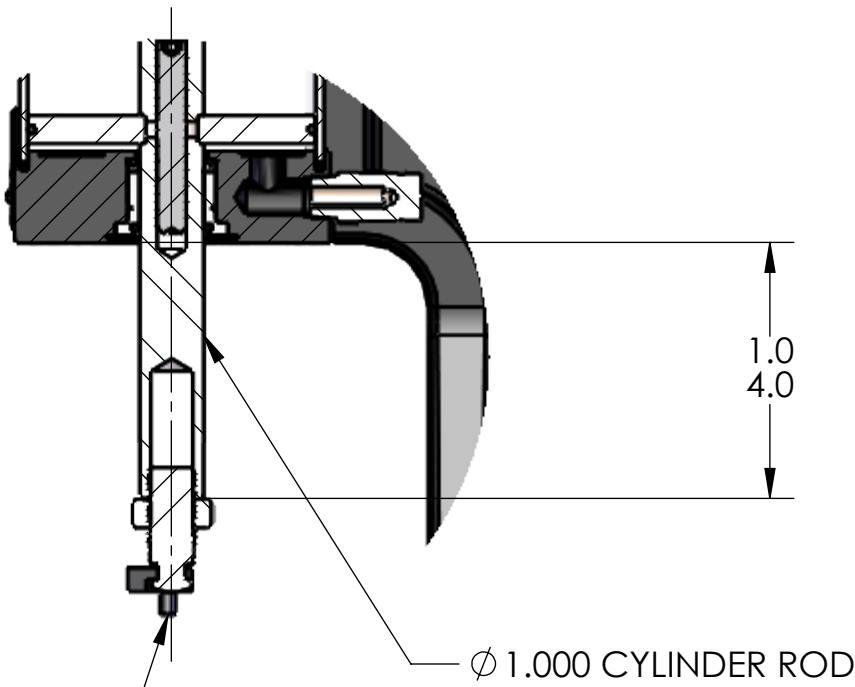
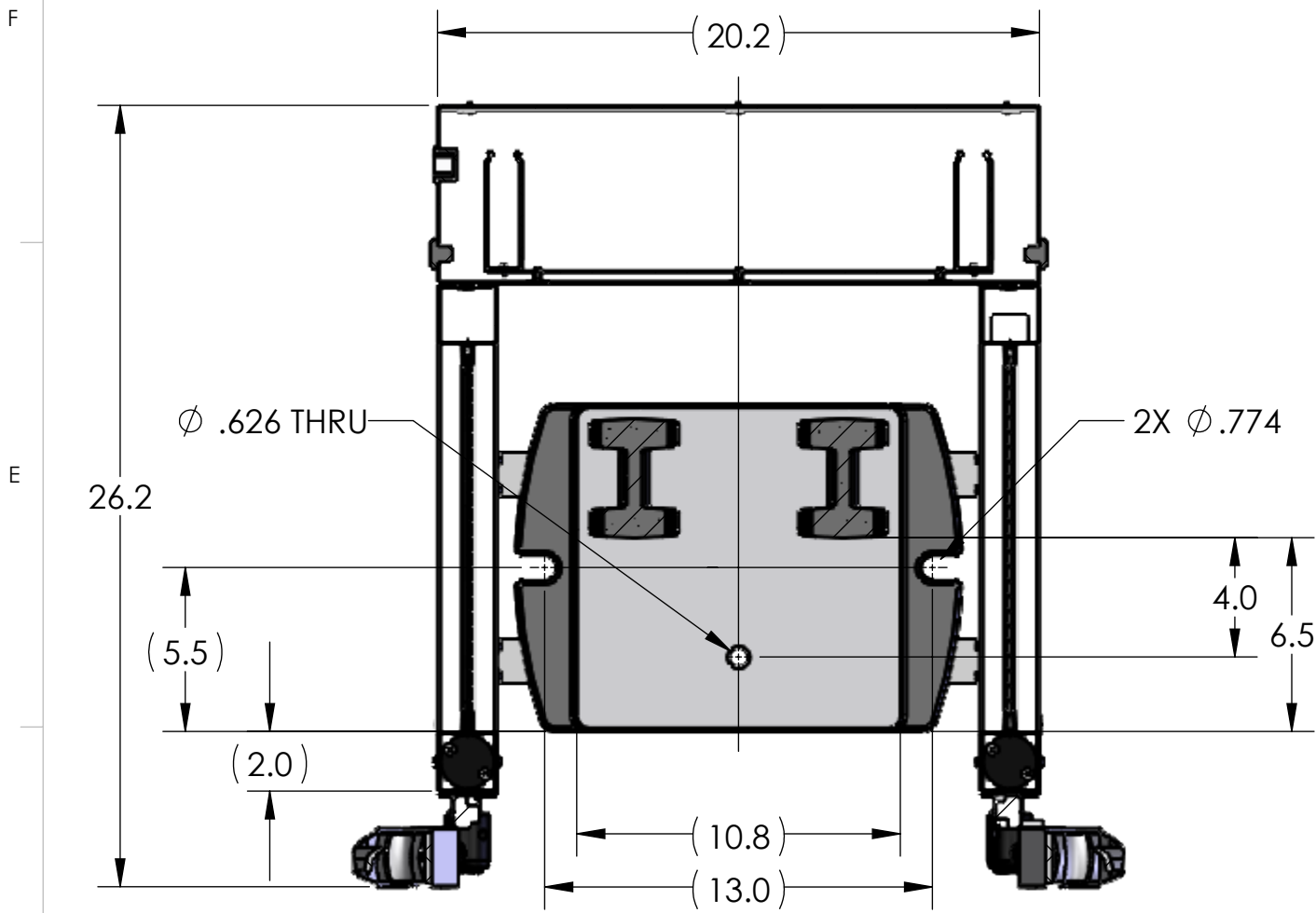
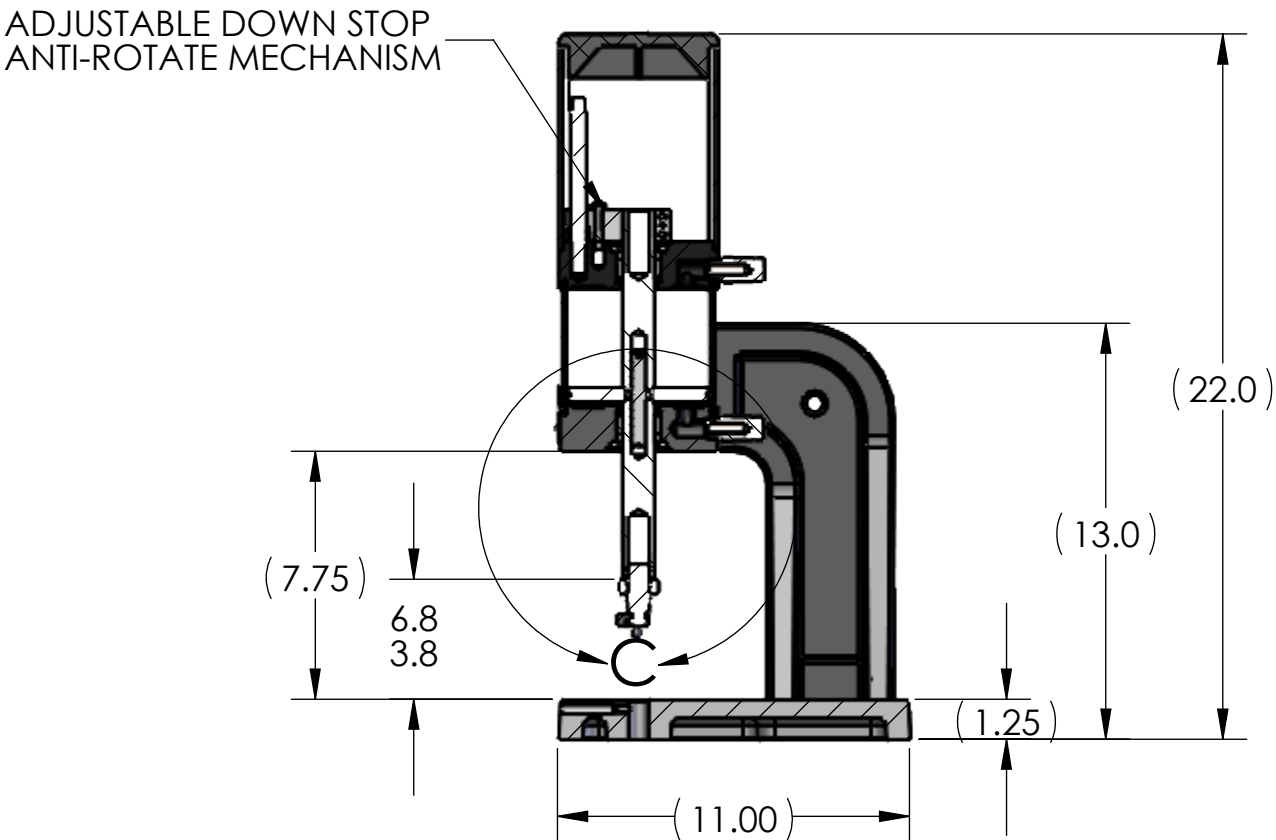
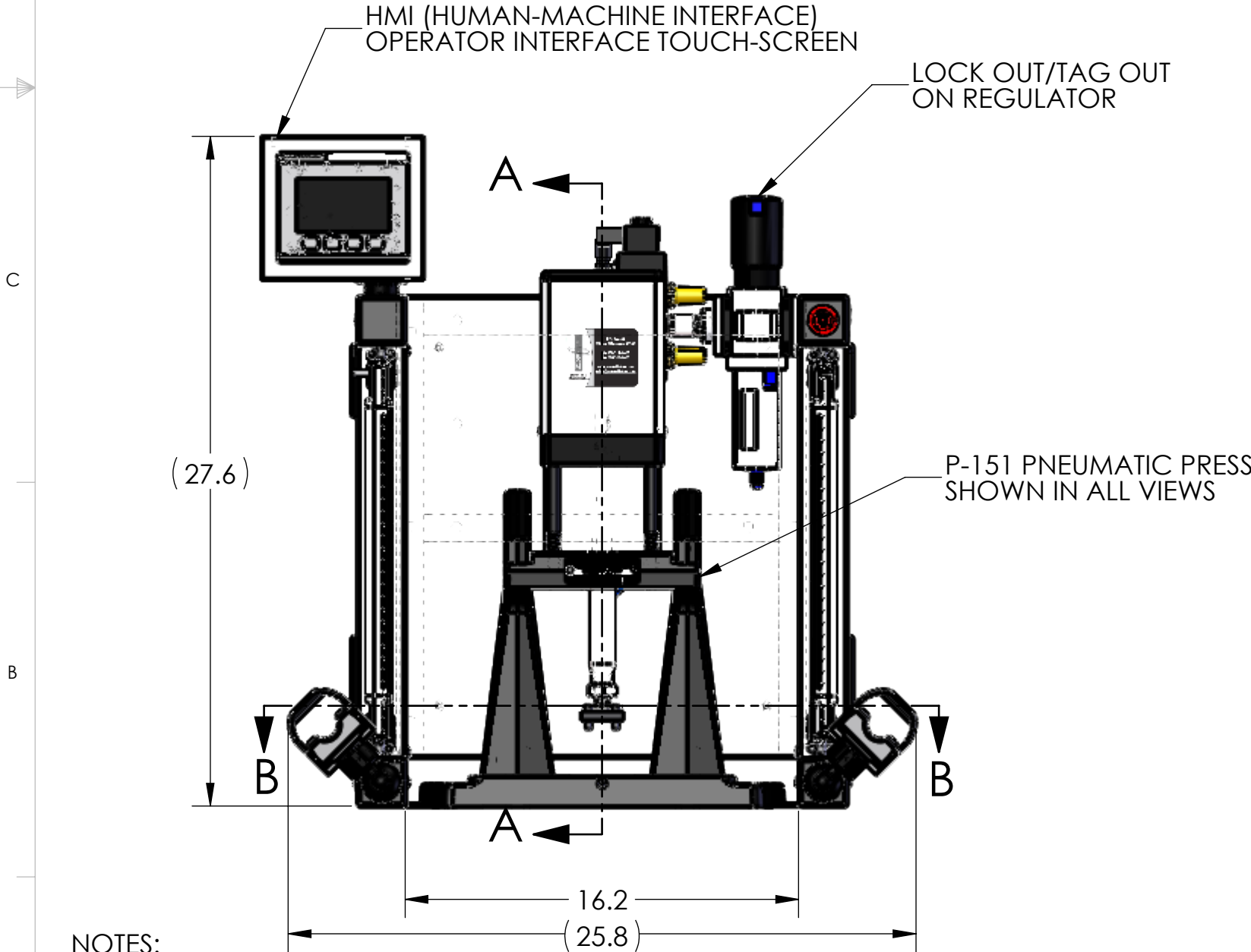

NOTES:

1. PRESS OPERATES ON LOW VOLTAGE (24V DC).
2. LED LIGHT COMES STANDARD.
3. OPTIONAL FORCE MONITORING SYSTEM AVAILABLE UPON REQUEST (NOT SHOWN).
4. OPTIONAL 500-15 ASSEMBLY BUSHING AVAILABLE UPON REQUEST (NOT SHOWN).
5. CYLINDER ROD SHOWN IN EXTENDED POSITION.
6. ALL CYLINDERS COME STANDARD WITH 3" OF STROKE.
LONGER CYLINDER STROKE LENGTHS AVAILABLE UPON REQUEST (UP TO 12").
7. OPTIONAL RISER BLOCKS AVAILABLE UPON REQUEST.
8. LIGHT CURTAIN, E-STOP AND TOOL ADAPTER SHOWN DO NOT COME STANDARD.
9. REMOVED GUARD IN RIGHT VIEW FOR CLARITY.

THIS DRAWING WAS PRINTED ON 1/28/2021

UNLESS OTHERWISE SPECIFIED:			
DRAWN	NAME	DATE	
CHECKED	RKM	1/28/21	
ENG APPR.			
MFG APPR.			
Q.A.			
COMMENTS:			
BREAK ALL SHARP EDGES			
DO NOT SCALE DRAWING			

PROPRIETARY AND CONFIDENTIAL
THE INFORMATION CONTAINED IN THIS
DRAWING IS THE SOLE PROPERTY OF
JANESVILLE TOOL & MANUFACTURING INC.
ANY REPRODUCTION IN PART OR AS A WHOLE
WITHOUT THE WRITTEN PERMISSION OF
JANESVILLE TOOL & MANUFACTURING INC. IS
PROHIBITED.

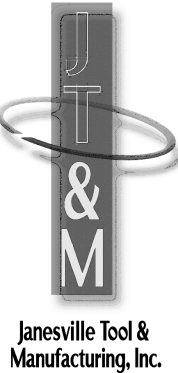

Janesville Tool & Manufacturing Inc. 3930 Enterprise Drive Janesville, WI 53546 Phone: 608-314-1620, Fax 608-314-1625		
TITLE: P-151 SINGLE STAGE		
SIZE C	DWG. NO. P-151-000-00	REV -
SCALE: 1:6	WEIGHT: 162.80	SHEET 1 OF 3