

FULLY ADJUSTABLE OPTO TOUCH BUTTONS

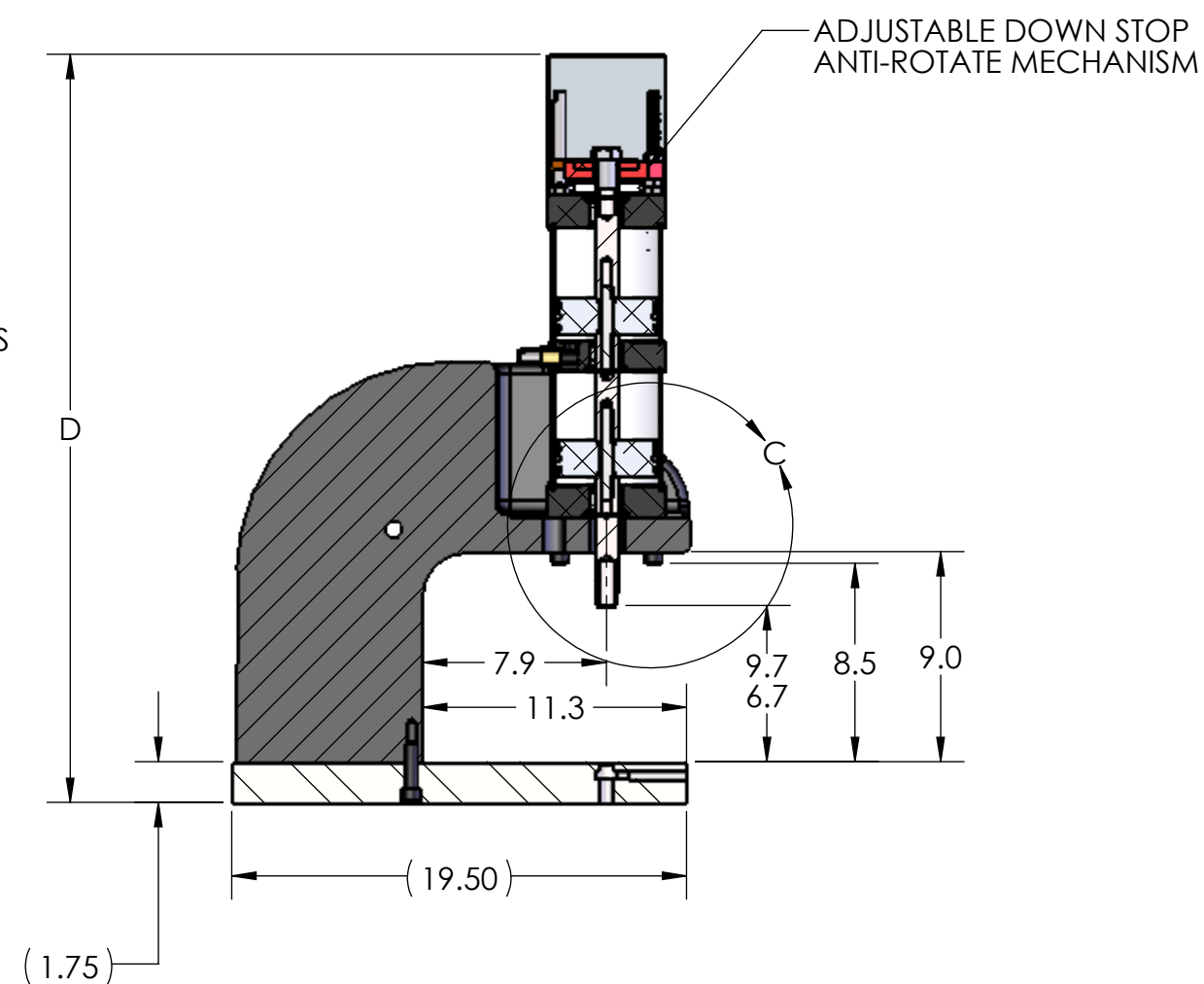

MODEL #	D DIMENSION	FORCE @ 80 PSI
P-8302	32.1	2416 LBS

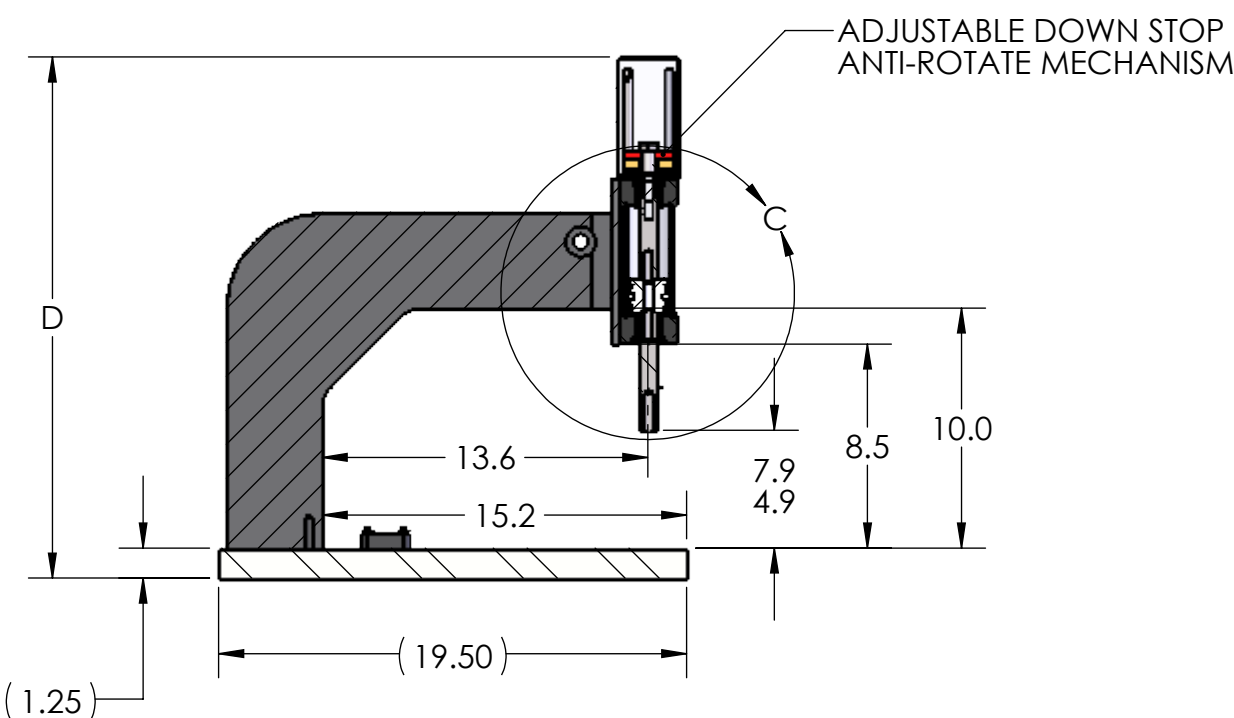
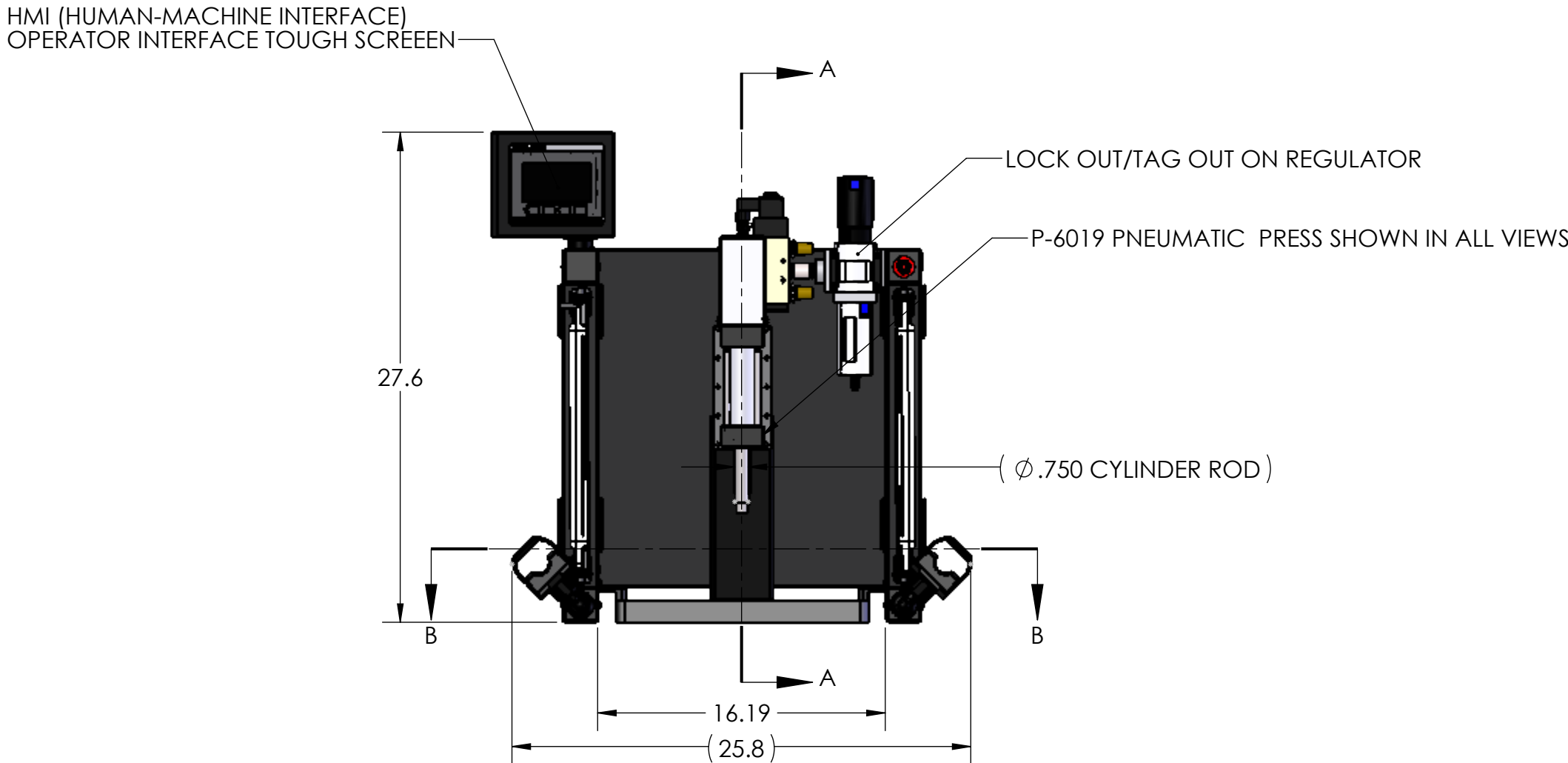
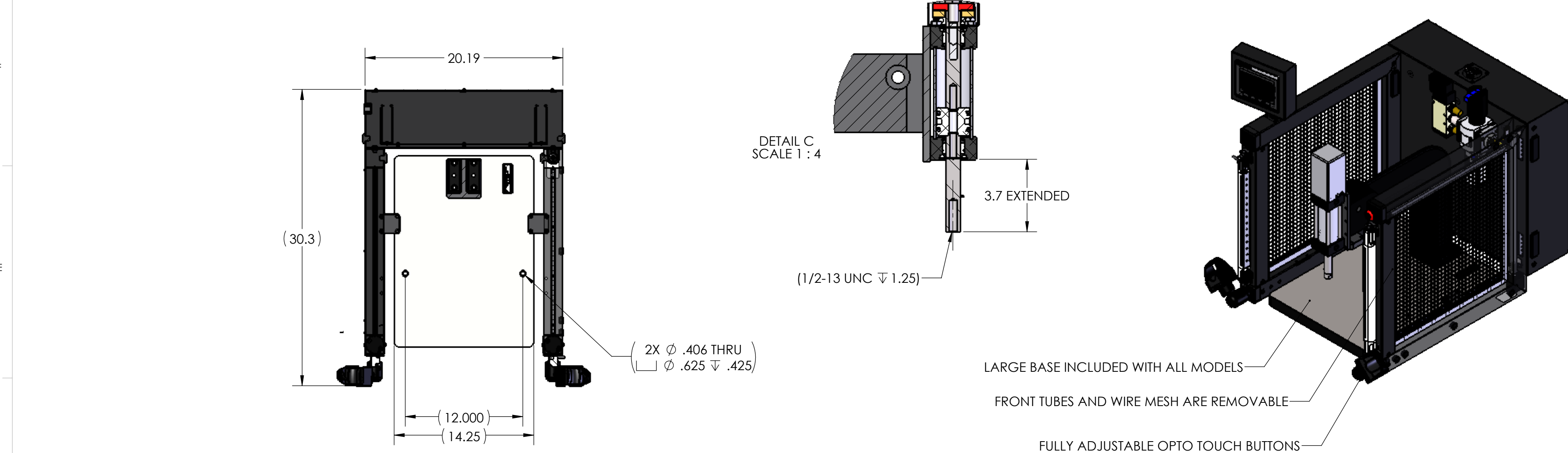

- NOTES:
1. PRESS OPERATES ON LOW DC VOLTAGE(24VDC).
 2. LED LIGHT COMES STANDARD.
 3. FORCE MONITORING SYSTEM DOES NOT COME STANDARD.
 4. ALL CYLINDERS COME STANDARD WITH 3 INCHES OF STROKE.
(LONGER CYLINDER STROKE LENGTHS AVAILABLE UPON REQUEST)
 5. OPTIONAL RISER BLOCKS AVAILABLE UPON REQUEST.
 6. LIGHT CURTAIN AND E-STOP SHOWN DO NOT COME STANDARD.
 7. REMOVED GUARD IN RIGHT VIEW FOR CLARITY.

MODEL #	D DIMENSION	FORCE @ 80 PSI
P-6019	21.7	152 LBS

THIS DRAWING WAS PRINTED ON 11/7/2017

PROPRIETARY AND CONFIDENTIAL
THE INFORMATION CONTAINED IN THIS DRAWING IS THE SOLE PROPERTY OF JANESVILLE TOOL & MANUFACTURING INC. ANY REPRODUCTION IN PART OR AS A WHOLE WITHOUT THE WRITTEN PERMISSION OF JANESVILLE TOOL & MANUFACTURING INC. IS PROHIBITED.

UNLESS OTHERWISE SPECIFIED: DIMENSIONS ARE IN INCHES TOLERANCES: FRACTIONAL \pm 0.15 ANGULAR: MACH \pm 0.5 BEND \pm 0.5 TWO PLACE DECIMAL \pm 0.01 THREE PLACE DECIMAL \pm 0.005 FOUR PLACE DECIMAL \pm 0.0005 INTERPRET GEOMETRIC TOLERANCING PER: ASME Y14.5-1994	SEE DETAILS
MATERIAL	SEE DETAILS
FINISH	DO NOT SCALE DRAWING

NAME	DATE
DRAWN RMC	9/27/17
CHECKED	
ENG APPR.	
MFG APPR.	
Q.A.	
COMMENTS:	
BREAK ALL SHARP EDGES	

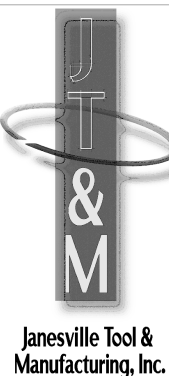

Janesville Tool & Manufacturing Inc. 3930 Enterprise Drive Janesville, WI 53546 Phone: 608-314-1620, Fax 608-314-1625		
TITLE: P-6000 SERIES		
SIZE C	DWG. NO. P-6000-000-00	REV -
SCALE: 1:8	WEIGHT: 429.52	SHEET 2 OF 3

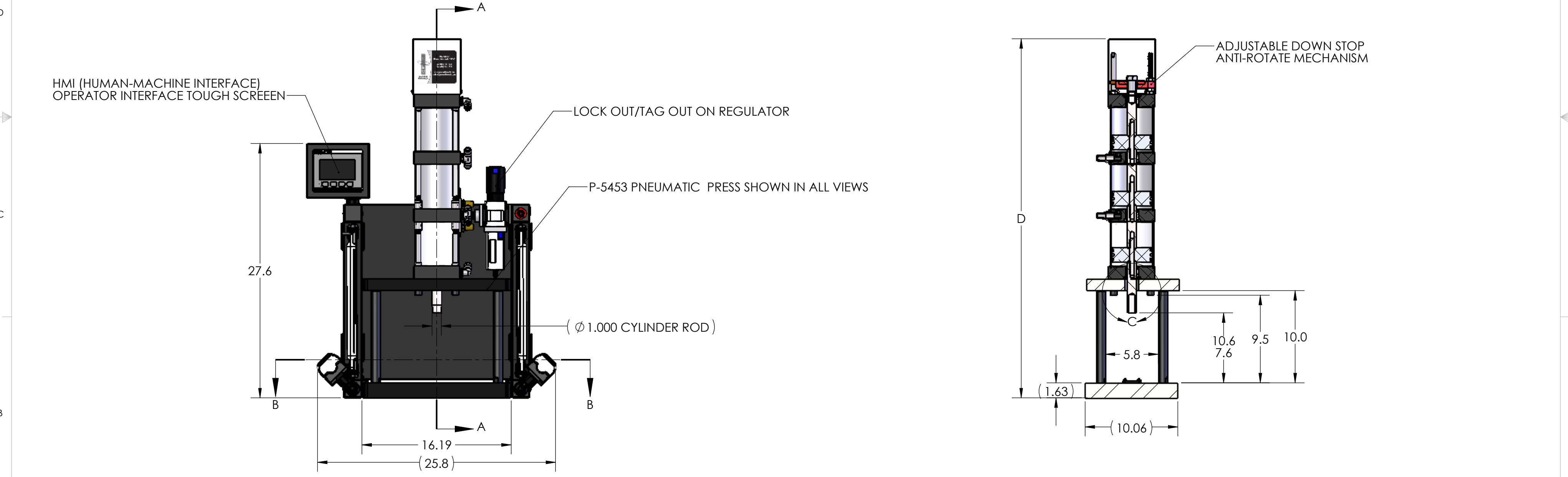
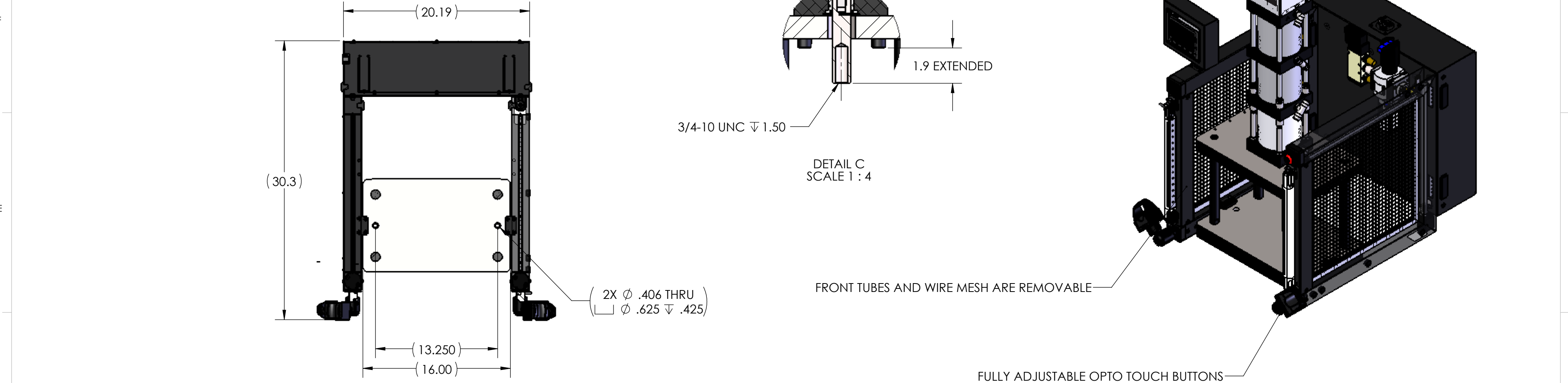

NOTES:

1. PRESS OPERATES ON LOW DC VOLTAGE(24VDC).
2. LED LIGHT COMES STANDARD.
3. FORCE MONITORING SYSTEM DOES NOT COME STANDARD.
4. ALL CYLINDERS COME STANDARD WITH 3 INCHES OF STROKE.
(LONGER CYLINDER STROKE LENGTHS AVAILABLE UPON REQUEST)
5. OPTIONAL RISER BLOCKS AVAILABLE UPON REQUEST.
6. LIGHT CURTAIN AND E-STOP SHOWN DO NOT COME STANDARD.
7. REMOVED GUARD IN RIGHT VIEW FOR CLARITY.

MODEL #	D DIMENSION	FORCE @ 80 PSI
P-5453	38.9	3624 LBS

PROPRIETARY AND CONFIDENTIAL
THE INFORMATION CONTAINED IN THIS DRAWING IS THE SOLE PROPERTY OF JANESVILLE TOOL & MANUFACTURING INC. ANY REPRODUCTION IN PART OR AS A WHOLE WITHOUT THE WRITTEN PERMISSION OF JANESVILLE TOOL & MANUFACTURING INC. IS PROHIBITED.

UNLESS OTHERWISE SPECIFIED: DIMENSIONS ARE IN INCHES TOLERANCES: FRACTIONAL: ± 0.15 ANGULAR: MACH ± 0.5 BEND ± 0.5 TWO PLACE DECIMAL ± 0.01 THREE PLACE DECIMAL ± 0.005 FOUR PLACE DECIMAL ± 0.0005 INTERPRET GEOMETRIC TOLERANCING PER: ASME Y14.5-1994	SEE DETAILS
MATERIAL	SEE DETAILS
FINISH	DO NOT SCALE DRAWING

THIS DRAWING WAS PRINTED ON 11/7/2017

NAME	DATE
RMC	9/27/17
ENG APPR.	
MFG APPR.	
Q.A.	
COMMENTS:	

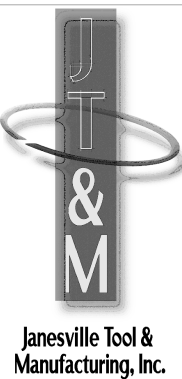

Janesville Tool & Manufacturing Inc. 3930 Enterprise Drive Janesville, WI 53546 Phone: 608-314-1620, Fax 608-314-1625		
TITLE: P-6000 SERIES		
SIZE C	DWG. NO. P-5000-000-00	REV -
SCALE: 1:8 WEIGHT: 429.52 SHEET 3 OF 3		