

REGULATED PRESSURE	FORCE
60 PSI	4868
80 PSI	6491
100 PSI	8114

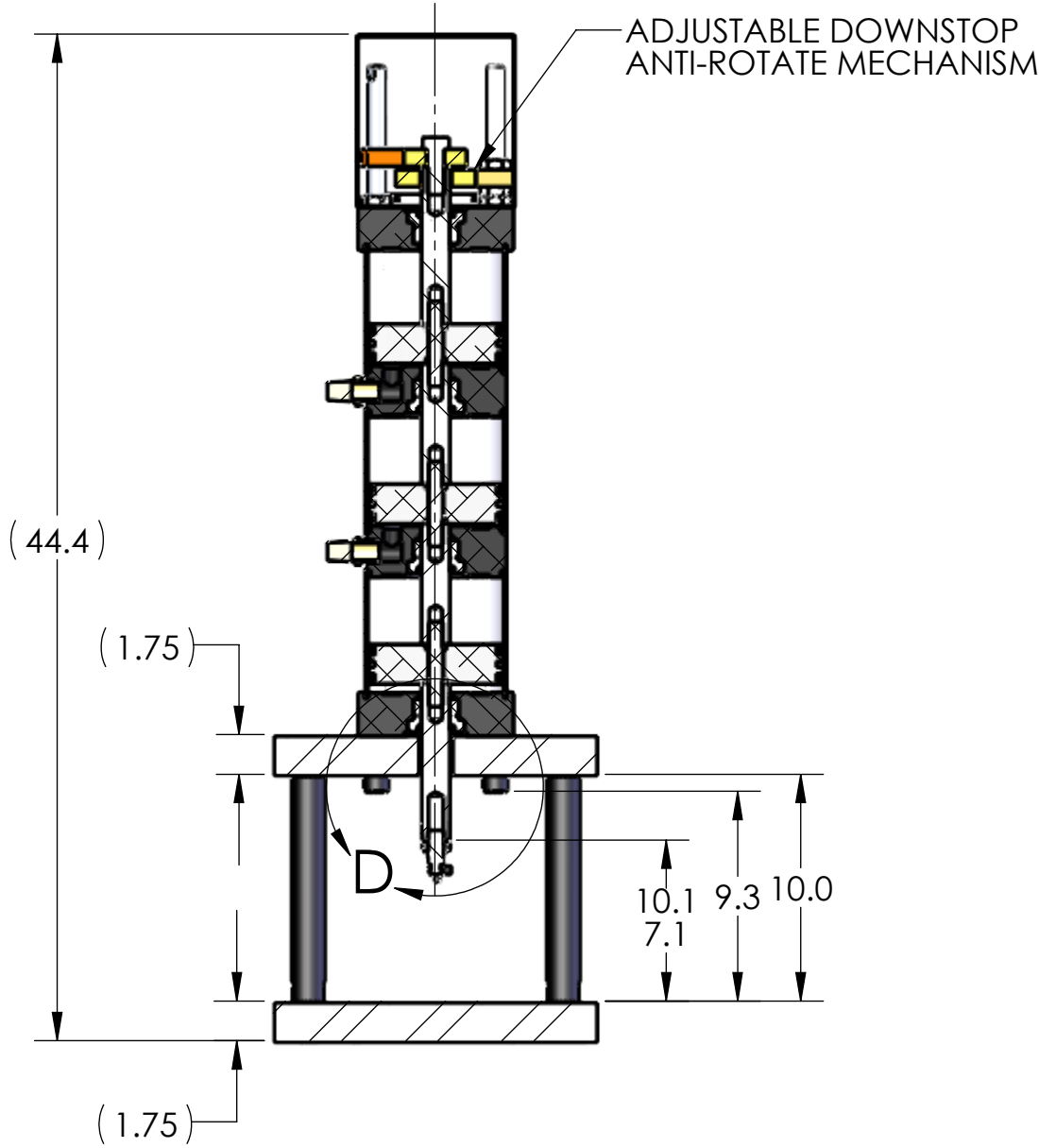
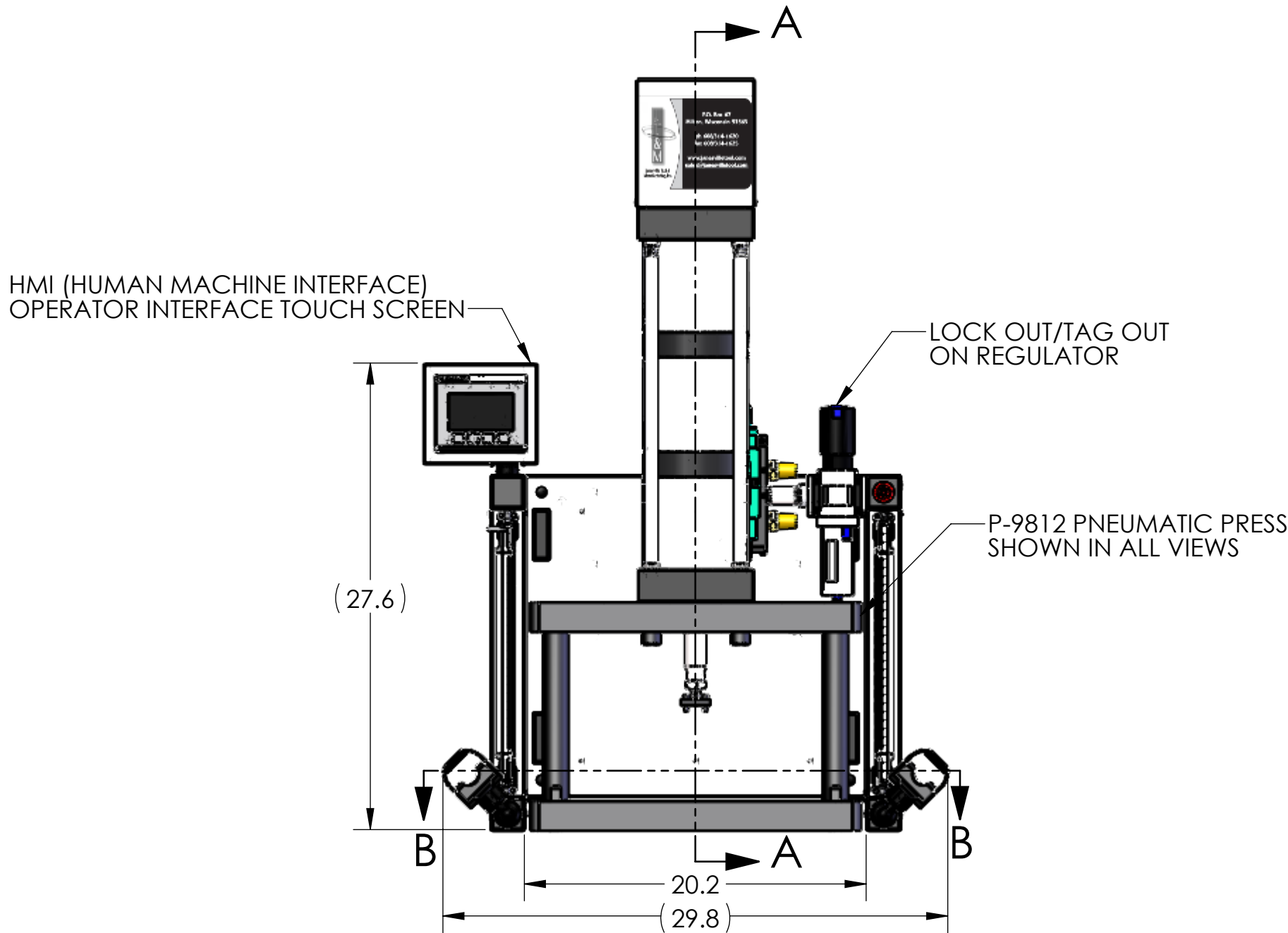
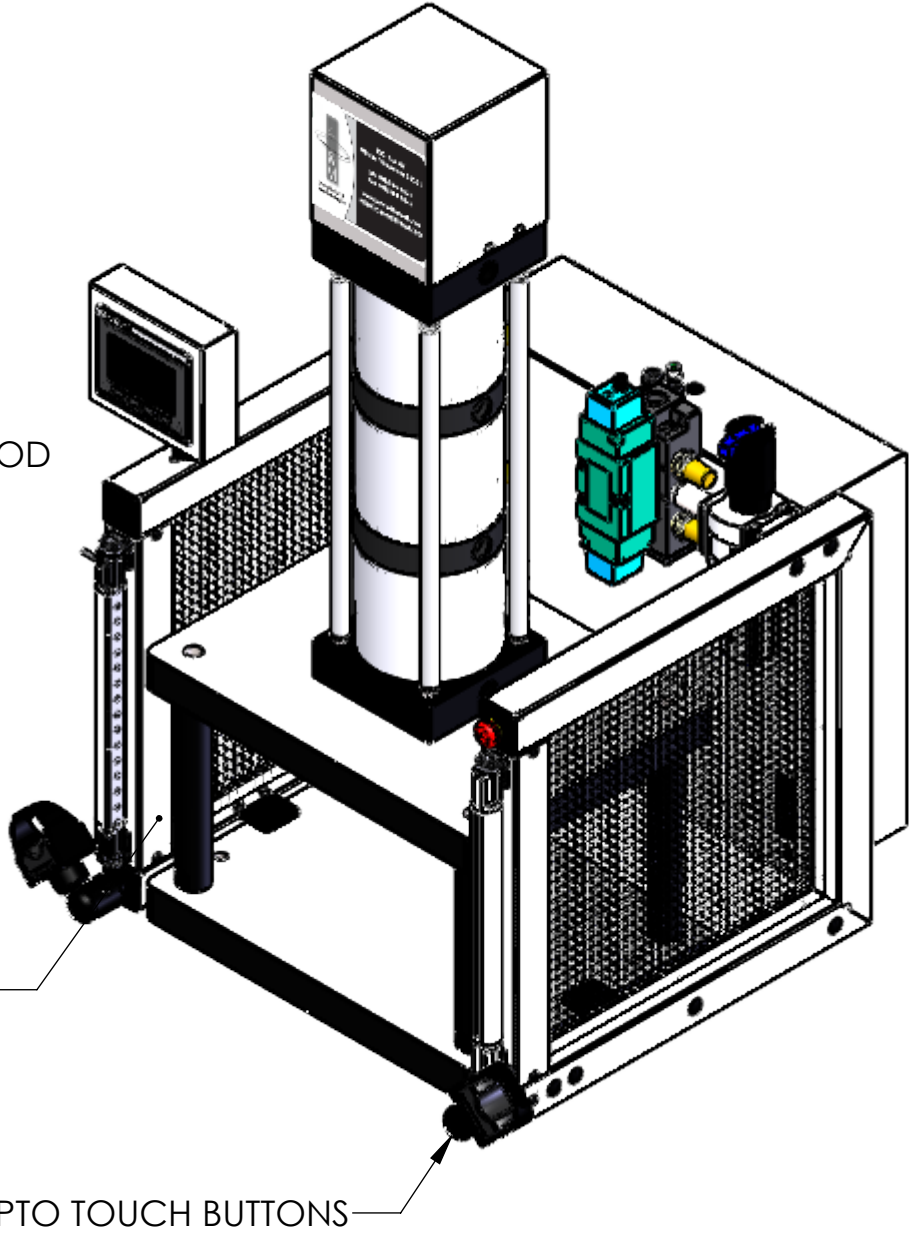
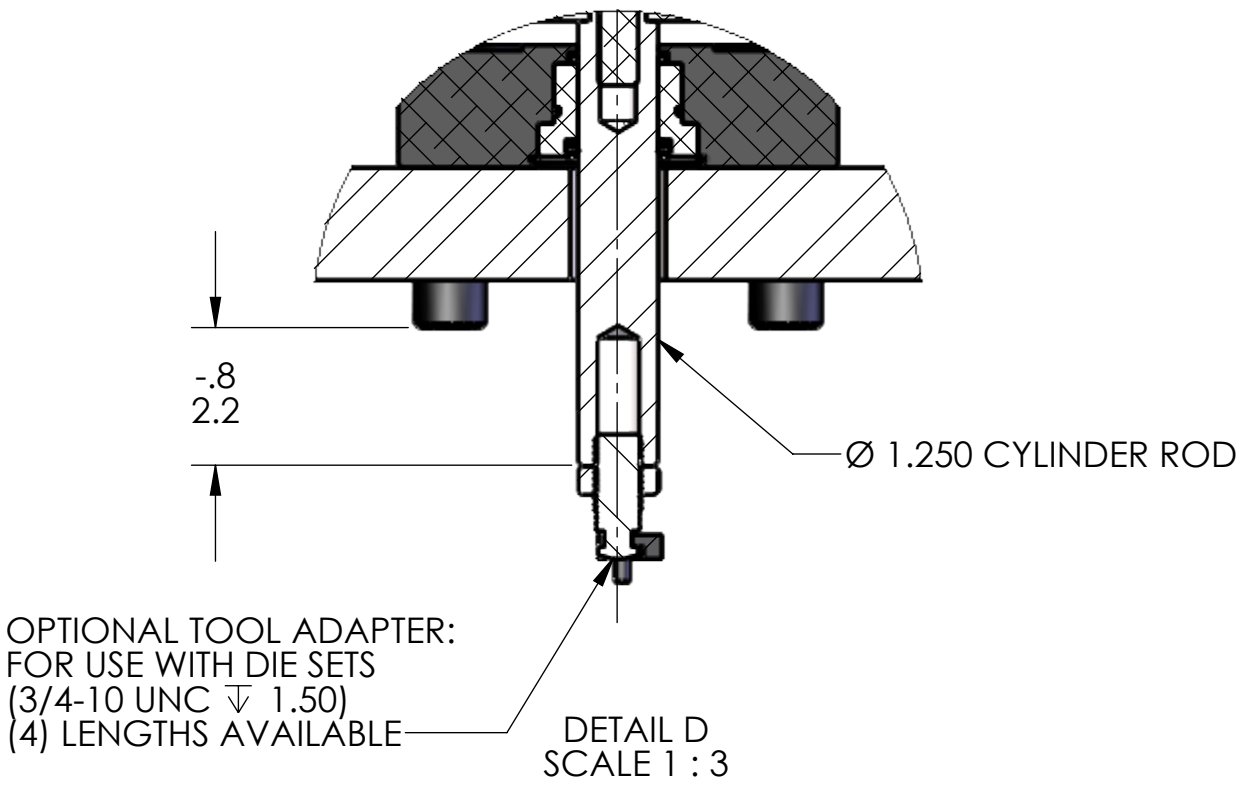
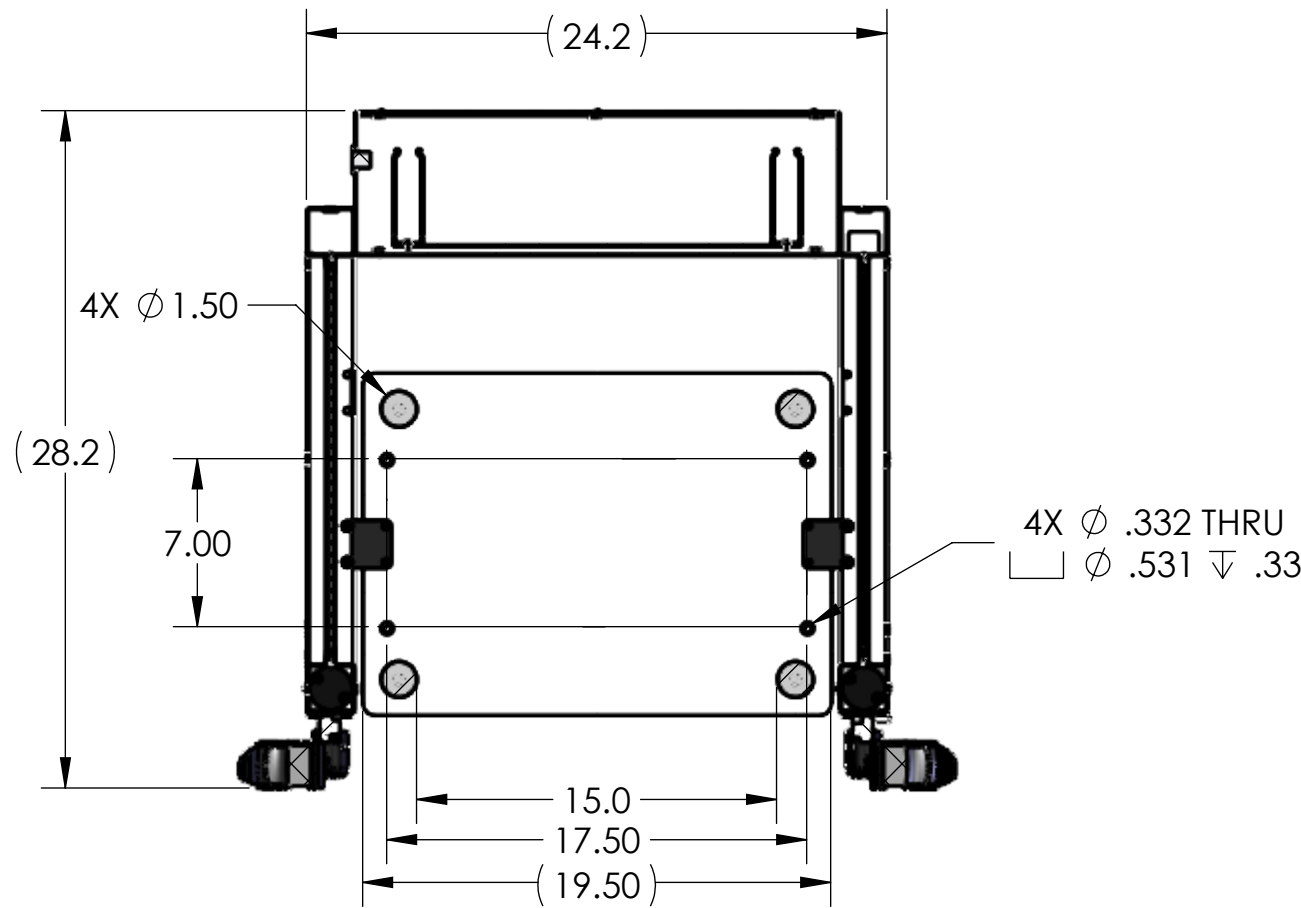

- NOTES:
- PRESS OPERATES ON LOW VOLTAGE (24V DC).
 - LED LIGHT COMES STANDARD.
 - OPTIONAL FORCE MONITORING SYSTEM AVAILABLE UPON REQUEST (NOT SHOWN).
 - CYLINDER ROD SHOWN IN EXTENDED POSITION.
 - ALL CYLINDERS COME STANDARD WITH 3" OF STROKE.
LONGER CYLINDER STROKE LENGTHS AVAILABLE UPON REQUEST (UP TO 12").
 - PRESS COMES STANDARD WITH 10" LONG POSTS.
ALTERNATE POST LENGTHS AVAILABLE UPON REQUEST (UP TO 18").
 - LIGHT CURTAIN, E-STOP AND TOOL ADAPTER SHOWN DO NOT COME STANDARD.
 - REMOVED GUARD IN RIGHT VIEW FOR CLARITY.

THIS DRAWING WAS PRINTED ON 9/1/2021

PROPRIETARY AND CONFIDENTIAL
THE INFORMATION CONTAINED IN THIS
DRAWING IS THE SOLE PROPERTY OF
JANESVILLE TOOL & MANUFACTURING INC.
ANY REPRODUCTION IN PART OR AS A WHOLE
WITHOUT THE WRITTEN PERMISSION OF
JANESVILLE TOOL & MANUFACTURING INC. IS
PROHIBITED.

UNLESS OTHERWISE SPECIFIED: DIMENSIONS ARE IN INCHES TOLERANCES: FRACTIONAL: ± 0.15 ANGULAR: MACH ± 0.5 BEND ± 0.5 TWO PLACE DECIMAL ± 0.01 THREE PLACE DECIMAL ± 0.005 FOUR PLACE DECIMAL ± 0.0005 INTERPRET GEOMETRIC TOLERANCING PER: ASME Y14.5-1994 MATERIAL FINISH SEE DETAILS DO NOT SCALE DRAWING	DRAWN CHECKED ENG APPR. MFG APPR. Q.A. COMMENTS:	NAME RKM BREAK ALL SHARP EDGES	DATE 4-19-21
--	---	---	---

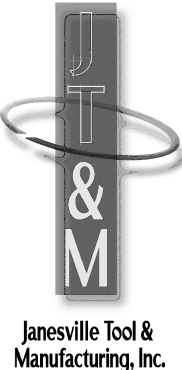

Janesville Tool & Manufacturing Inc. 3930 Enterprise Drive Janesville, WI 53546 Phone: 608-314-1620, Fax 608-314-1625			
TITLE: P-9812 THREE STAGE			
SIZE C	DWG. NO. P-9812-000-00	REV -	
SCALE: 1:8	WEIGHT: 439.97	SHEET 4 OF 5	